

# TOP FILL FOR DF SHELVING CORNER

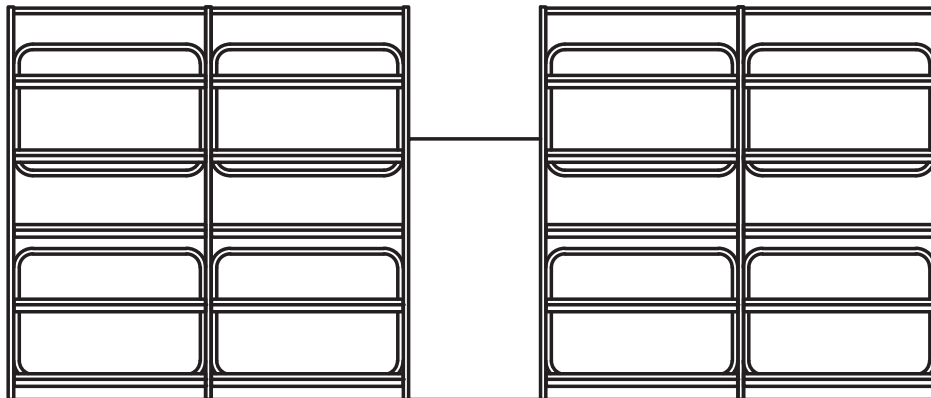

- SHELVING UNITS INSTALLED AS SHOWN W/  $\frac{3}{8}$ " OVERLAP/SETBACK.
- SHELVING TOP FILL PANEL PROVIDED WITH 1" X 1" X 2" L BRACKETS AND SCREWS.
- SPECIFY SHELVING DEPTH, 20" OR 24"D
- WHERE DIFFERENT HEIGHT SHELVING MEETS, INSTALL EQUAL HEIGHT W/ THE TOP OF THE SHORTER UNIT.

## TOP FILL FOR SF SHELVING CORNER

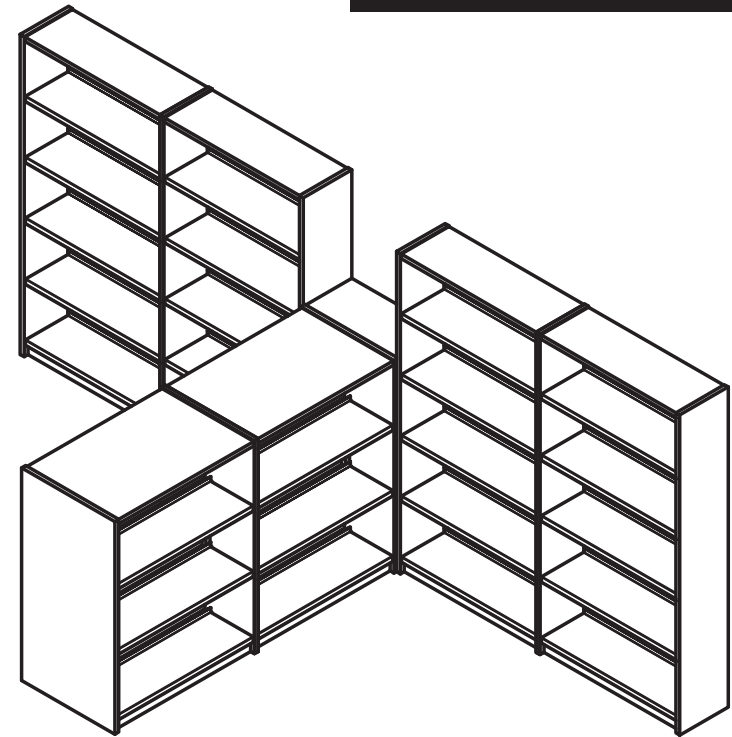
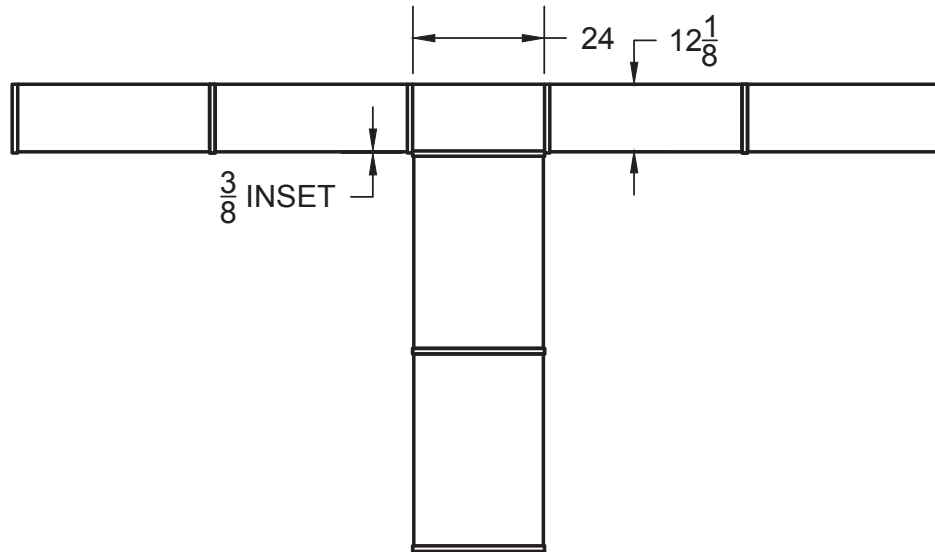
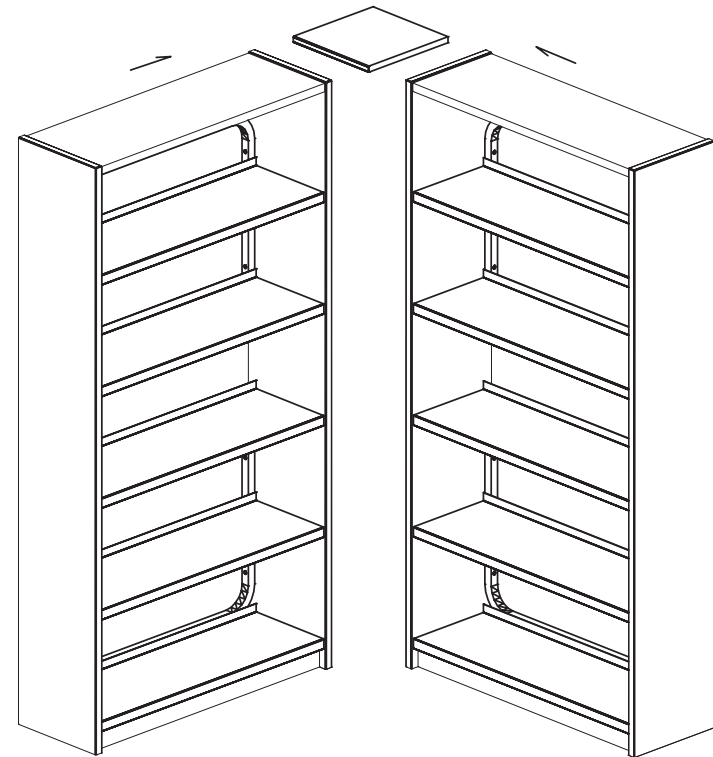
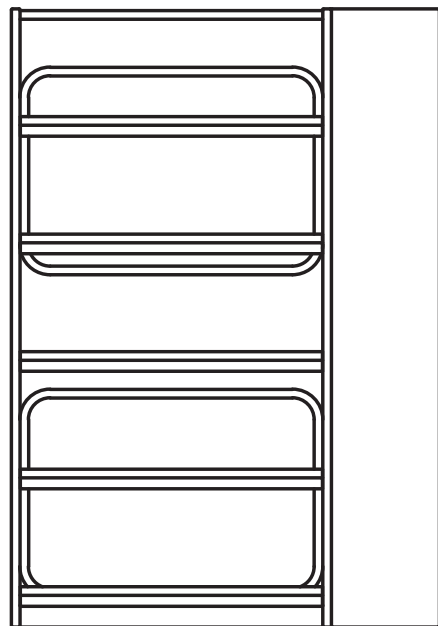
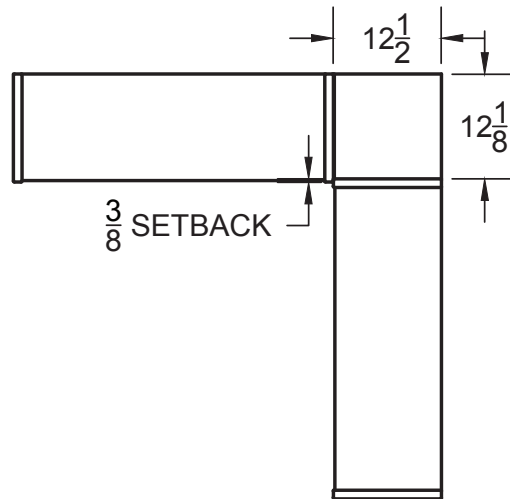

- SHELVING UNITS INSTALLED AT CORNER AS SHOWN W/  $\frac{3}{8}$ " OVERLAP/SETBACK.
- SF SHELVING CORNER TOP FILL PANEL PROVIDED WITH 1" X 1" X 2" L BRACKETS AND SCREWS.
- SPECIFY SHELVING DEPTH, 10" OR 12"D
- WHERE DIFFERENT HEIGHT SHELVING MEETS, INSTALL EQUAL HEIGHT W/ THE TOP OF THE SHORTER UNIT.

TOP & FACE FILL FOR SF SHELVING END

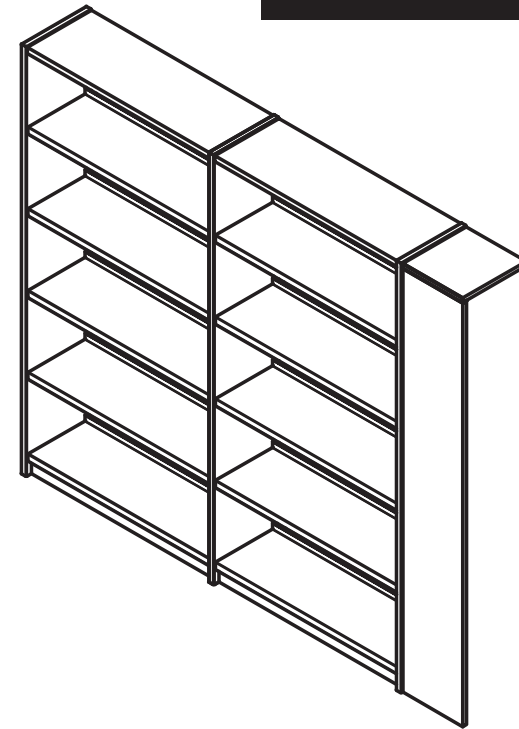
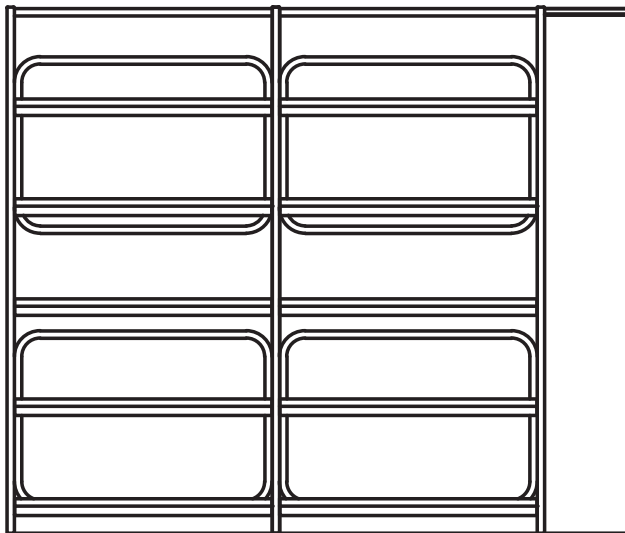
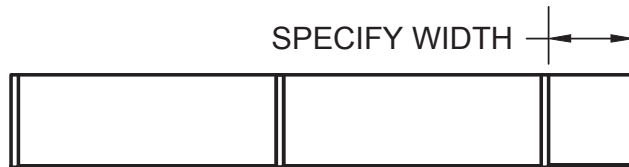

- TOP & FACE FILL PANEL PROVIDED WITH 1" X 1" X 2" L BRACKETS AND SCREWS.
- SPECIFY SHELVING DEPTH, 10" OR 12"D
- SPECIFY FILLER HEIGHT & WIDTH