



Bola Collection

media center • commons • classroom











BOLA
BOL-R45018



BOLA TEEN
BOL-R45015



BOLA JUNIOR
BOL-R45013



BOLA STOOL - MOBILE
BOL-R45518-4C



BOLA JUNIOR STOOL
BOL-R45513



BOL-R44103
* Bola with Arms



BOL-R44003
* Bola old-style, Capped Front Leg Armless Chair

*Bola old-style, Capped Front Leg Armless chairs and Bola with Arms are only available for customers who already have this Bola chair as a part of an existing seating program.

Chairs & Stools Quick Guide

	Arc	Bola	Hannah	Smile	Bella	Romak	Platform	Heritage
Base Style								
4 Post	•	•	•	•	•	•		
Stacker		•	•	•		•		
Sled Base	•							
Rocker								•
Glides	•	•	•	•	•	•	•	
Mobile			•					
Disc								
Footring								
Swivel-Tilt-Task	•		•					
Heights								
Jr. Height		•						•
Chair Height	•	•	•	•	•	•	•	•
Counter Stool Height	•		•	•	•	•	•	
Café Stool Height	•		•		•	•		
Features								
Backless		•					•	
Arms	•		•					•
Armless	•	•	•	•	•	•	•	
Handle Cut Out						•		
Book Rack			•					
Tablet Arm								
Storage Cart		•	•	•		•		
Materials								
Thermoplastic	•	•	•	•				
Upholstery	•	•	•		•		•	
Veneer	•				•	•		•
Sprayon					•	•		•
Laminate	•				•	•	•	
Powder Coat	•	•	•	•	•	•	•	

PRODUCT PAIRINGS & KITS

Bola Junior & Bola for Children Table Pairing

(A) (4) Bola Junior Stool - BOL-R45513

(B) (1) Bola for Children Table - BOL-C0036-21

Footprint as shown is
5.3'D x 5.4'W

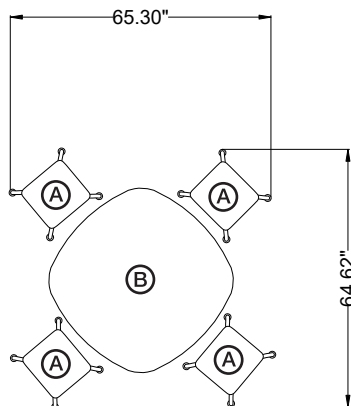
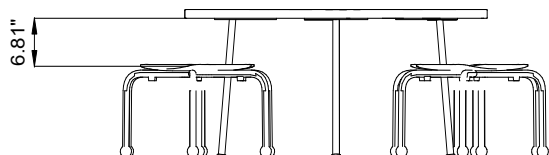

Bola Chair with Rockford Desk

(A) (1) Rockford crescent table - RF-C3672CR

(B) (1) Bola - BOL-R45018

Kit Footprint as Shown:
3.8' D X 2.3' W

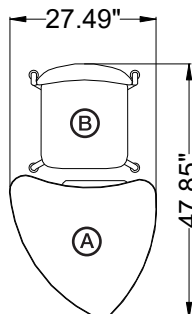
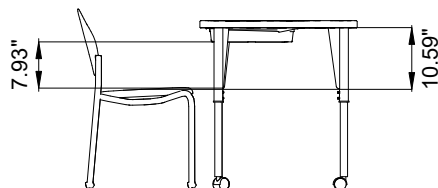

Gather & Bola Stool Kit Products

(A) (1) Bola Stool - Mobile - BOL-R45518-4C

(B) (1) Rockford Gather Table - RF-C3672GTH

(C) (4) Dotti - DOTTI-16

Kit Footprint as Shown:
4.4' D X 7.2' W

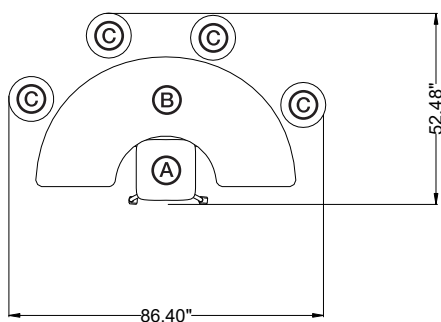
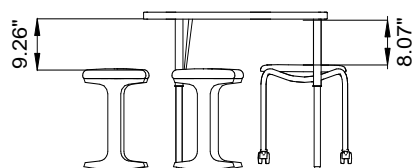

Features & Benefits:



- Formerly an izzy+/Fixtures Furniture product, the Bola's signature design offers simple, classic comfort with the fun attitude of colorful thermoplastics or fabrics.
- Rolled steel front legs and fixed back legs can be fitted with ball or formal glides.
- Stackable up to four high!
- Seat and back can be upholstered or textured thermoplastic.
- Available, as a chair or stool, in three seat heights (17", 15" & 13").

To Order Specify

Seat: Choose from our selection of thermoplastic colors and fabrics.

Frame: Choose from our selection of powder coats.

Ball Glides (if applicable): Choose thermoplastic color(s).

Arm (if applicable): Choose thermoplastic for inserts.

See mediatechnologies' finish selections at
<https://www.mediatechnologies.com/resources/finishes>

View our fabric choices at
<https://www.mediatechnologies.com/resources/fabrics>

Model Number Breakdown

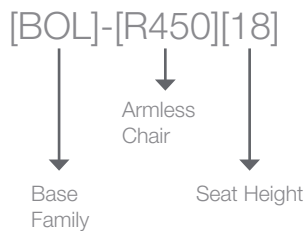

Options



Formal
Glide



Nylon Ball
Glide



Stacker Arm

BOLA

Benches



BOLB-C2060C

20"D X 60"W X 18"H

BOLA



BOLB-C2060C
with Ball Glides



BOLB-C2060C
with Formal Glides

BOLA BENCH

- Upholstered seat cushion on a 1-1/4" HPL base with 3mm PVC edgebanding.
- Available in 48" and 60" widths.
- Sturdy, powder coated steel legs.
- Available with nylon ball glides or formal glides (Black only)

BOLA BENCH STANDARD SIZES

MODEL	DEPTH"	WIDTH"	HEIGHT"
BOLB-C1848C	20	48	18
BOLB-C1860C	20	60	18

Ball Glide Color Options

T11 swan
T12 raven
T13 blue heron
T14 jay
T15 falcon
T16 dove
T17 woodpecker red
T18 purple martin
T19 peacock
T20 macaw blue
T21 goldfinch
T22 parakeet
T23 oriole
T24 cardinal
T25 flamingo

Powder Coat Options

809 Silver
109 Cream
112 White
208 Putty
304 Dove Grey
405 Charcoal
407 Stone
501 Red
502 Lime Green
509 Tangerine
5003 Navy
701 Capri Blue
808 Nickel
903 Black Wrinkle
912 Black

To Order, Choose Finish Selections & Options

Base: Choose from our selection of powder coats. Choose either ball glides or formal glides (Black only). If ball glides are chosen, indicate desired color(s). Note: there is an upcharge for multiple color ball glides.

Seat: Choose from our selection of graded fabrics. Make a PVC edge band selection.

See **mediatechnologies'** finish selections at
<https://www.mediatechnologies.com/resources/finishes>
View our fabric choices at
<https://www.mediatechnologies.com/resources/fabrics>

General Specifications

Legs: 1" diameter, 16-gauge tubular steel leg is fully welded to a 1/4" thick steel mounting plate. Mounting plate is attached to the base with 1/4"-20 bolts and threaded inserts. Each leg is fitted with a molded nylon ball (standard) or formal glide option. Formal glides are available in T12 Raven (Black) only. (Note: 48" wide model has 4 legs, 60" wide model has 6 legs.)

Cushioned Seat: 1-1/2" thick high density upholstery foam with a 1/2" thick backer board attaches to a 1-1/4" thick HPL core with 3mm PVC banding and 2" radiused corners. Cushioned tops are attached with wood screws.



cs-bolabench-200123

892 Industrial Park Drive
Shelby, MI 49455
P: 231.861.2194
F: 231.861.6678
www.mediatechnologies.com
sales@mediatechnologies.com

PURE MICHIGAN®

BOLA

Tables



BOL-C0036-21

36"Dia. x 21"H

*Shown with multi-color ball glide option.

BOLA

BOLA TABLE STANDARD SIZES

BOLA RECTANGLE STANDARD SIZES

MODEL	DEPTH"	WIDTH"	HEIGHT"
BOL-C2442R	24	42	27/29
BOL-C3042R-	30	42	27/29
BOL-C3048R-	30	48	27/29
BOL-C3060R-	30	60	27/29
BOL-C3648R-	36	48	27/29
BOL-C3660R-	36	60	27/29

BOLA SQUARE STANDARD SIZES

MODEL	DEPTH"	WIDTH"	HEIGHT"
BOL-C2424R-	24	24	27/29
BOL-C3030R-	30	30	27/29
BOL-C3636R-	36	36	27/29
BOL-C4242R-	42	42	27/29
BOL-C4848R-	48	48	27/29

BOLA ROUND STANDARD SIZES

MODEL	DIA"	HEIGHT"
BOL-C0036-	36	27/29
BOL-C0042-	42	27/29
BOL-C0048-	48	27/29
BOL-C0054-	54	27/29

BOLA RAETSEL STANDARD SIZES

MODEL	DEPTH"	WIDTH"	HEIGHT"
BOL-C4565RL-	45	65	27/29

BOLA BEANIE STANDARD SIZES

MODEL	DEPTH"	WIDTH"	HEIGHT"
BOL-C3060BNR-	29.25	58.375	27/29

BOLA FLAIR STANDARD SIZES

MODEL	DEPTH"	WIDTH"	HEIGHT"
BOL-C3060FLR-	32.25	59.5	27/29

BOLA SPROCKET STANDARD SIZES

MODEL	DEPTH"	WIDTH"	HEIGHT"
BOL-C6060S-	60	60	27/29

BOLA PICK STANDARD SIZES

MODEL	DEPTH"	WIDTH"	HEIGHT"
BOLP-C4042-	40	42	27/29

BOLA SQUIRCL STANDARD SIZES

MODEL	DEPTH"	WIDTH"	HEIGHT"
BOL-C0042SQR-	42	42	27/29
BOL-C0048SQR-	48	48	27/29
BOL-C0054SQR-	54	54	27/29
BOL-C6060SQR-	60	60	27/29

BOLA TABLE FOR CHILDREN STANDARD SIZES

BOLA FOR CHILDREN RECTANGLE

MODEL	DEPTH"	WIDTH"	HEIGHT"
BOL-C2442R	24	42	21/24
BOL-C3042R-	30	42	21/24
BOL-C3048R-	30	48	21/24
BOL-C3060R-	30	60	21/24
BOL-C3648R-	36	48	21/24
BOL-C3660R-	36	60	21/24

BOLA FOR CHILDREN SQUARE

MODEL	DEPTH"	WIDTH"	HEIGHT"
BOL-C2424R	24	24	21/24
BOL-C3030R-	30	30	21/24
BOL-C3636R-	36	36	21/24
BOL-C4242R-	42	42	21/24
BOL-C4848R-	48	48	21/24

BOLA FOR CHILDREN ROUND

MODEL	DIA"	HEIGHT"
BOL-C0036-	36	21/24
BOL-C0042-	42	21/24
BOL-C0048-	48	21/24
BOL-C0054-	54	21/24

BOLA FOR CHILDREN RAETSEL

MODEL	DEPTH"	WIDTH"	HEIGHT"
BOL-C4565RL-	45	65	21/24

BOLA FOR CHILDREN BEANIE

MODEL	DEPTH"	WIDTH"	HEIGHT"
BOL-C3060BNR-	29.25	58.375	21/24

BOLA FOR CHILDREN FLAIR

MODEL	DEPTH"	WIDTH"	HEIGHT"
BOL-C3060FLR-	32.25	59.5	21/24

BOLA FOR CHILDREN SPROCKET

MODEL	DEPTH"	WIDTH"	HEIGHT"
BOL-C6060S-	60	60	21/24

BOLA FOR CHILDREN PICK

MODEL	DEPTH"	WIDTH"	HEIGHT"
BOLP-C4042-	40	42	21/24

BOLA FOR CHILDREN SQUIRCL

MODEL	DEPTH"	WIDTH"	HEIGHT"
BOL-C0036SQR-	36	36	21/24
BOL-C0042SQR-	42	42	21/24
BOL-C0048SQR-	48	48	21/24
BOL-C0054SQR-	54	54	21/24
BOL-C6060SQR-	60	60	21/24

BOLA



BOL-C3060R-29
Rectangle



BOL-C3636R-29
Square



BOL-C0036-29
Round



BOL-C3660BNR-29
Beanie



BOL-C3660FLR-29
Flair



BOL-C4042-29
Pick



BOL-C4565RL-29
Raetsel



BOL-C6060S-29
Sprocket



BOL-C4242SQR-29
Squircle

BOLA TABLE

- Molded nylon balls adorn the base of each leg, making Bola tables uniquely fun for kids and adults alike.
- Formal glides are available as an option in.
- High pressure laminate work surface sits atop four 14-gauge steel tube legs.
- Work surfaces are available in a variety of shapes including: Rectangle, Square, Round, Raetsel, Beanie, Flair, Sprocket, Squircle and Pick.
- Edges are 3mm PVC.

To Order, Choose Finish Selections & Options

Work Surface: Choose from our selection of high pressure laminates.

Edges: Choose from our selection of PVC edgebands.

Legs: Choose from our powder coat selection.

Glides: Choose from our thermoplastic selection for standard ball glides, or choose the formal glide option. Ball glides can be a variety of colors for an additional charge. Formal glides come standard in T12 Raven.

See **mediatechnologies'** finish choices at
<https://www.mediatechnologies.com/resources/finishes>

● FORMAL GLIDE



● BALL GLIDE



General Specifications

Work Surface: Table tops are 1-1/4" thick, with a 1-1/8" thick, three-ply particleboard core with .050 high pressure laminate top and a .030" or thicker phenolic backer. Edges are 3mm PVC. Squared corners and corners on Beanie, Flair and Sprocket tops have a 2" radius.

Legs: 1" x 14-gauge steel tube with molded nylon ball (standard) or formal glide option. Meets or exceeds ANSI/BIFMA X5.5 durability and safety standards.

Ships KD.

Bola tables do not stack.



cs-bolatables-210817

892 Industrial Park Drive
Shelby, MI 49455
P: 231.861.2194
F: 231.861.6678
www.mediatechnologies.com
sales@mediatechnologies.com

PURE MICHIGAN®