

General Specifications

End Panels:

All end panels are constructed of 1" engineered wood with high pressure laminate on both faces; exposed edges are banded with 3mm PVC with edges and corners radiused 1/8".

Browser Box:

The upper browser box is 35"L x 23-3/4"W x 5-7/8"D with 3/4" thick long sides and bottom. Vertical back partition is 1" thick. \ Browser boxes are engineered with dowel and glue construction. Bins have (11) holes for adjusting 1/4" diameter finished steel rod. All items are engineered wood with high pressure laminate on both faces with 3mm PVC bands.

Base:

The toe assembly is a 4" high box frame constructed of 1" thick 9 ply hardwood plywood. The toe assembly is bolted to the end and intermediate panels using 5/16" - 18 machine bolts.

Mobile Option:

A steel chassis is installed inside of the toe assembly. Casters are bolted to the chassis with 1/4"-20 bolts and nylon insert lock nuts and the entire assembly is attached to the end panel with 5/16"-18 machine bolts. The steel chassis provides formed flanges under the toe and end panels for extra support. The casters are 2" diameter, non-locking. The mobile bookcase sits 1/2" off the floor. To Specify add -MOB.

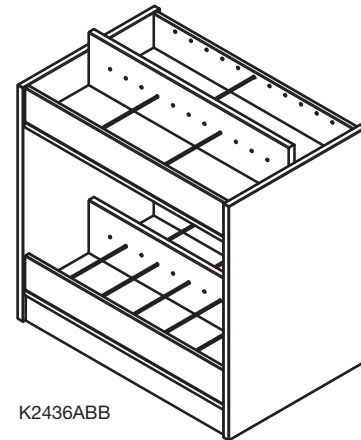

K2436ABB

Browser - Browser Bin, HPL

Model Number	Description	List Price
K2436ABBL-J	Mobile Browser Bin 36"W X 24"D x 30"H, HPL	\$2,739
K2436ABBL-J-MOB	Mobile Browser Bin 36"W X 24"D x 30"H, HPL	\$2,905
K2436ABBL	Mobile Browser Bin 36"W X 24"D x 36"H, HPL	\$2,739
K2436ABBL-MOB	Mobile Browser Bin 36"W X 24"D x 36"H, HPL	\$2,905

Browser - Browser Bin, TFL

Model Number	Description	List Price
K2436ABBT-J	Mobile Browser Bin 36"W X 24"D x 30"H,TFL	\$2,116
K2436ABBT-J-MOB	Mobile Browser Bin 36"W X 24"D x 30"H,TFL	\$2,328
K2436ABBT	Mobile Browser Bin 36"W X 24"D x 36"H,TFL	\$2,116
K2436ABBT-MOB	Mobile Browser Bin 36"W X 24"D x 36"H,TFL	\$2,328

Set Up Charges and Upcharges for Non-Standard and Custom Finishes

Model Number	Description	List Price
Non-Standard PVC	Upcharge, per color, per order, for non-standard PVC	\$947
Custom Finish	Upcharge for custom stain finish	\$701
Non-Standard Stain	Upcharge for non-standard stains already matched	\$304
Sprayon Finish	Upcharge, per color, per order, for Sprayon finish	\$361

Required to order: Model # including options if applicable

- HPL Selection
- Wood finish selection
- Wood or PVC edge selection

Note: Prices for items with wood veneer or edges is based on oak. Use of maple or other species may incur an upcharge.