

CAKE DISPLAY

Display

General Specifications

General Construction: Assembly consists of three 1" display shelves and three curved tiers that all rest on a base plate with casters for mobility. All joinery is concealed and uses primarily glue and dowel and/or blind pocket holes and screws. Concealed joint connector bolts hold the tier levels together.

Tier Construction: Each tier uses stud construction consisting of a round sub-top and bottom panel along with vertical studs all made from furniture grade engineered panels. Stud wall assembly is wrapped with curved engineered panels and finished with either wood veneer or High-pressure laminate.

Display Shelves (if HPL construction): Shelves are 1" thick nine ply hardwood plywood with .035" thick high pressure laminate both faces; exposed edges are banded with 3mm PVC with edges radiused 1/8".

Display Shelves (if wood construction): shelves are 1" thick nine ply hardwood plywood with wood veneer on both faces; exposed edges are banded with 8mm hardwood and edges radiused 1/4".

Dimensions: Bottom and mid display shelves are 48" diameter, top shelf is 28" diameter. 48" cylindrical veneer base is 16" high and conceals five 2" swivel casters. Cylindrical mid veneer base is 33" and 28" in diameter. Top shelf base is 28" in diameter and 45-1/2" high.

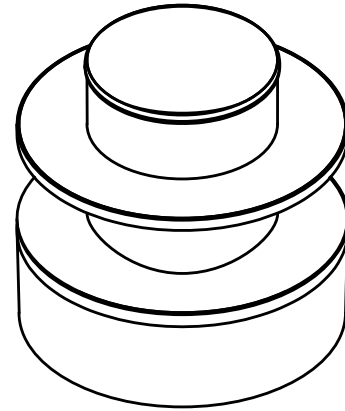

Cake Display - Round Platform Mobile Display		
Oak with HPL Horizontal Surfaces		
3C-F0048-45-MOB	28" Dia. X 45.5"H	\$6,703
Maple with HPL Horizontal Surfaces		
3C-F0048M-45-MOB	28" Dia. X 45.5"H	\$6,703
HPL with PVC Edges		
3C-C0048L-45-MOB	28" Dia. X 45.5"H	\$5,396

Required to order: Model # including options if applicable

- HPL Selection, if applicable
- Wood finish selection, if applicable
- PVC selection, if applicable
- Wood edge selection, if applicable

Set Up Charges and Upcharges for Non-Standard and Custom Finishes		
Model Number	Description	List Price
Non-Standard PVC	Upcharge, per color, per order, for non-standard PVC	\$947
Custom Finish	Upcharge for custom stain finish	\$701
Non-Standard Stain	Upcharge for non-standard stains already matched	\$304
Sprayon Finish	Upcharge, per color, per order, for Sprayon finish	\$361