

PLEASE NOTE: The prices below are for reference only and are base models constructed of HPL work surfaces, TFL cabinets and doors with standard pulls, standard hinges and without locks. For detailed pricing please contact your local dealer or **mediatechnologies®**.

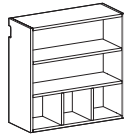

- 2 adjustable shelves

Wall Open Storage (WOS)			
Model Number	Description	Wgt.	List Price
SWOS-181424	18"W x 14"D x 24"H	36	\$503
SWOS-181430	18"W x 14"D x 30"H	39	\$506
SWOS-181436	18"W x 14"D x 36"H		\$578
SWOS-241424	24"W x 14"D x 24"H	44	\$509
SWOS-241430	24"W x 14"D x 30"H	47	\$522
SWOS-241436	24"W x 14"D x 36"H		\$643
SWOS-301424	30"W x 14"D x 24"H	52	\$552
SWOS-301430	30"W x 14"D x 30"H	55	\$560
SWOS-301436	30"W x 14"D x 36"H		\$675
SWOS-361424	36"W x 14"D x 24"H	59	\$604
SWOS-361430	36"W x 14"D x 30"H	63	\$626
SWOS-361436	36"W x 14"D x 36"H		\$771
SWOS-421424	42"W x 14"D x 24"H	73	\$698
SWOS-421430	42"W x 14"D x 30"H	78	\$716
SWOS-421436	42"W x 14"D x 36"H		\$900



- 1 adjustable shelf
- 18" & 24" W units will have 2 lower cubbies
- 30" & 36" W will have 3 lower cubbies

Wall Open Storage with Cubicle Storage (SWOSCB3)			
Model Number	Description	Wgt.	List Price
SWOSCB3-301430	30"W x 14"D x 30"H	58	\$581
SWOSCB3-301436	30"W x 14"D x 36"H		\$803
SWOSCB3-361430	36"W x 14"D x 30"H	67	\$667
SWOSCB3-361436	36"W x 14"D x 36"H		\$964
SWOSCB3-421430	42"W x 14"D x 30"H	82	\$802
SWOSCB3-421436	42"W x 14"D x 36"H		\$1,124



- 2 adjustable shelves

Wall Cupboard Storage (WCS)			
Model Number	Description	Wgt.	List Price
SWCS-241424	24"W x 14"D x 24"H	58	\$794
SWCS-241430	24"W x 14"D x 30"H	64	\$832
SWCS-241436	24"W x 14"D x 30"H		\$1,028
SWCS-301424	30"W x 14"D x 24"H	68	\$884
SWCS-301430	30"W x 14"D x 30"H	76	\$925
SWCS-301436	30"W x 14"D x 36"H		\$1,125
SWCS-361424	36"W x 14"D x 24"H	79	\$972
SWCS-361430	36"W x 14"D x 30"H	88	\$1,014
SWCS-361436	36"W x 14"D x 36"H		\$1,350
SWCS-421424	42"W x 14"D x 24"H	96	\$1,073
SWCS-421430	42"W x 14"D x 30"H	111	\$1,137
SWCS-421436	42"W x 14"D x 36"H		\$1,157

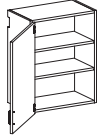

- 1 door hinged left
- 2 adjustable shelves

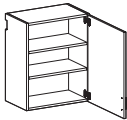

- 1 door hinged right
- 2 adjustable shelves

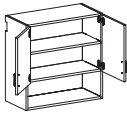

- 1 adjustable shelf



- 1 adjustable shelf
- 24" W units will have 2 lower cubbies
- 30" & 36" W units will have 3 lower cubbies

Wall Cupboard Storage Hinged Left (SWCSL)

Model Number	Description	Wgt.	List Price
SWCSL-181424	18"W x 14"D x 24"H	45	\$659
SWCSL-181430	18"W x 14"D x 30"H	51	\$694
SWCSL-181436	18"W x 14"D x 36"H		\$868
SWCSL-241424	24"W x 14"D x 24"H	57	\$708
SWCSL-241430	24"W x 14"D x 30"H	64	\$832
SWCSL-241436	24"W x 14"D x 36"H		\$1,028

Wall Cupboard Storage Hinged Right (SWCSR)

Model Number	Description	Wgt.	List Price
SWCSR-181424	18"W x 14"D x 24"H	45	\$659
SWCSR-181430	18"W x 14"D x 30"H	51	\$694
SWCSR-181436	18"W x 14"D x 36"H		\$1,735
SWCSR-241424	24"W x 14"D x 24"H	57	\$708
SWCSR-241430	24"W x 14"D x 30"H	64	\$832
SWCSR-241436	24"W x 14"D x 36"H		\$857

Wall Cupboard Storage with Open Storage (SWCSOS)

Model Number	Description	Wgt.	List Price
SWCSOS-241424	24"W x 14"D x 24"H	58	\$899
SWCSOS-241430	24"W x 14"D x 30"H	64	\$949
SWCSOS-241436	24"W x 14"D x 36"H		\$1,157
SWCSOS-301424	30"W x 14"D x 24"H	68	\$1,003
SWCSOS-301430	30"W x 14"D x 30"H	76	\$1,045
SWCSOS-301436	30"W x 14"D x 36"H		\$1,157
SWCSOS-361424	36"W x 14"D x 24"H	79	\$1,095
SWCSOS-361430	36"W x 14"D x 30"H	88	\$1,136
SWCSOS-361436	36"W x 14"D x 36"H		\$1,542
SWCSOS-421424	42"W x 14"D x 24"H	100	\$1,188
SWCSOS-421430	42"W x 14"D x 30"H	111	\$1,500
SWCSOS-421436	42"W x 14"D x 36"H		\$1,799

Wall Cupboard Storage with Open Cubicle Storage (SWCSOCB3)

Model Number	Description	Wgt.	List Price
SWCSOCB3-241430	24"W x 14"D x 30"H	72	\$1,154
SWCSOCB3-241436	24"W x 14"D x 36"H		\$1,414
SWCSOCB3-301430	30"W x 14"D x 30"H	79	\$1,280
SWCSOCB3-301436	30"W x 14"D x 36"H		\$1,606
SWCSOCB3-361430	36"W x 14"D x 30"H	92	\$1,392
SWCSOCB3-361436	36"W x 14"D x 36"H		\$1,928

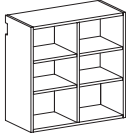

- 1 fixed partition
- 4 adjustable shelves

Wall Cubicle Storage - 6 Cubicles (WOCB6)			
Model Number	Description	Wgt.	List Price
SWOCB6-301424	30"W x 14"D x 24"H	55	\$638
SWOCB6-301430	30"W x 14"D x 30"H	58	\$670
SWOCB6-301436	30"W x 14"D x 36"H		\$803
SWOCB6-361424	36"W x 14"D x 24"H	64	\$705
SWOCB6-361430	36"W x 14"D x 30"H	67	\$730
SWOCB6-361436	36"W x 14"D x 36"H		\$964
SWOCB6-421424	42"W x 14"D x 24"H	78	\$716
SWOCB6-421430	42"W x 14"D x 30"H	82	\$750
SWOCB6-421436	42"W x 14"D x 36"H		\$900
SWOCB6-481424	48"W x 14"D x 24"H	87	\$719
SWOCB6-481430	48"W x 14"D x 30"H	92	\$751
SWOCB6-481436	48"W x 14"D x 36"H		\$1,028

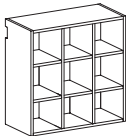

- 2 fixed vertical partitions
- 6 adjustable shelves

Wall Cubicle Storage - 9 Cubicles (SWOCB9)			
Model Number	Description	Wgt.	List Price
SWOCB9-301424	30"W x 14"D x 24"H	62	\$640
SWOCB9-301430	30"W x 14"D x 30"H	65	\$672
SWOCB9-301436	30"W x 14"D x 36"H		\$964
SWOCB9-361424	36"W x 14"D x 24"H	72	\$706
SWOCB9-361430	36"W x 14"D x 30"H	75	\$735
SWOCB9-361436	36"W x 14"D x 36"H		\$964
SWOCB9-421424	42"W x 14"D x 24"H	87	\$719
SWOCB9-421430	42"W x 14"D x 30"H	92	\$751
SWOCB9-421436	42"W x 14"D x 36"H		\$900
SWOCB9-481424	48"W x 14"D x 24"H	98	\$720
SWOCB9-481430	48"W x 14"D x 30"H	103	\$751
SWOCB9-481436	48"W x 14"D x 36"H		\$1,028

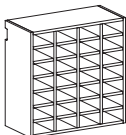

- 3 fixed vertical partitions
- 32 fixed shelves

Wall Cubicle Mail Storage (SWOCBM)			
Model Number	Description	Wgt.	List Price
SWOCBM-301430	30"W x 14"D x 30"H	72	\$937
SWOCBM-301436	30"W x 14"D x 36"H		\$1,125
SWOCBM-361430	36"W x 14"D x 30"H	83	\$1,086
SWOCBM-361436	36"W x 14"D x 36"H		\$1,349

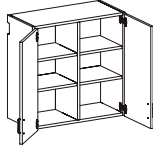

- 1 fixed vertical partition
- 4 adjustable shelves

Wall Cupboard Cubicle Storage - 6 Cubicles (WCCB6)			
Model Number	Description	Wgt.	List Price
SWCCB6-301424	30"W x 14"D x 24"H	75	\$1,249
SWCCB6-301430	30"W x 14"D x 30"H	83	\$1,284
SWCCB6-301436	30"W x 14"D x 36"H		\$1,766
SWCCB6-361424	36"W x 14"D x 24"H	87	\$1,334
SWCCB6-361430	36"W x 14"D x 30"H	96	\$1,393
SWCCB6-361436	36"W x 14"D x 36"H		\$1,735
SWCCB6-421424	42"W x 14"D x 24"H	105	\$1,420
SWCCB6-421430	42"W x 14"D x 30"H	116	\$1,478
SWCCB6-421436	42"W x 14"D x 36"H		\$1,799
SWCCB6-481424	48"W x 14"D x 24"H	118	\$1,423
SWCCB6-481430	48"W x 14"D x 30"H	130	\$1,479
SWCCB6-481436	48"W x 14"D x 36"H		\$1,799



- 2 fixed vertical partitions
- 6 adjustable shelves

Wall Cupboard Cubicle Storage - 9 Cubicles (SWCCB9)			
Model Number	Description	Wgt.	List Price
SWCCB9-301424	30"W x 14"D x 24"H	82	\$1,258
SWCCB9-301430	30"W x 14"D x 30"H	89	\$1,285
SWCCB9-301436	30"W x 14"D x 36"H		\$1,606
SWCCB9-361424	36"W x 14"D x 24"H	111	\$1,336
SWCCB9-361430	36"W x 14"D x 30"H	104	\$1,395
SWCCB9-361436	36"W x 14"D x 36"H		\$1,735
SWCCB9-421424	42"W x 14"D x 24"H	115	\$1,423
SWCCB9-421430	42"W x 14"D x 30"H	126	\$1,479
SWCCB9-421436	42"W x 14"D x 36"H		\$1,799
SWCCB9-481424	48"W x 14"D x 24"H	129	\$1,432
SWCCB9-481430	48"W x 14"D x 30"H	141	\$1,480
SWCCB9-481436	48"W x 14"D x 36"H		\$1,799



- 3 fixed vertical partitions
- 32 fixed shelves

Wall Cupboard Cubicle Mail Storage (SWCCBM)			
Model Number	Description	Wgt.	List Price
SWCCBM-301430	30"W x 14"D x 30"H	96	\$1,834
SWCCBM-301436	30"W x 14"D x 36"H		\$2,248
SWCCBM-361430	36"W x 14"D x 30"H	112	\$2,041
SWCCBM-361436	36"W x 14"D x 36"H		\$2,505



- 1 fixed vertical partition
- 20 fixed shelves

Wall Open Folio Storage (WOF)			
Model Number	Description	Wgt.	List Price
SWOF-301424	30"W x 14"D x 24"H	62	\$1,125
SWOF-301430	30"W x 14"D x 30"H	65	\$1,160
SWOF-301436	30"W x 14"D x 36"H		\$1,606
SWOF-361424	36"W x 14"D x 24"H	72	\$1,236
SWOF-361430	36"W x 14"D x 30"H	75	\$1,265
SWOF-361436	36"W x 14"D x 36"H		\$1,735



- 1 fixed vertical partition
- 20 fixed shelves

Wall Cupboard Folio Storage (WCF)			
Model Number	Description	Wgt.	List Price
SWCF-301424	30"W x 14"D x 24"H	82	\$1,642
SWCF-301430	30"W x 14"D x 30"H	89	\$1,693
SWCF-301436	30"W x 14"D x 36"H		\$2,248
SWCF-361424	36"W x 14"D x 24"H	95	\$1,808
SWCF-361430	36"W x 14"D x 30"H	104	\$1,858
SWCF-361436	36"W x 14"D x 36"H		\$2,505

Terms & Conditions

Prices: All prices are F.O.B. the factory. Prices and specifications are subject to change without notice. Prices do not include applicable taxes, special handling or installation charges. Possession of a price list is not an offer to or agreement to sell. We reserve the right to change prices without notice. We are not responsible for typographical errors. In the event a price or description is found to be incorrect, the correct information will be communicated to you when the order is received.

Credit Terms: Open account status is only granted after a completed credit application is received and approved.

Payment Terms: Terms for open account are net 30 days. Terms for orders without open account will be determined by Silver Street, Incorporated on an order-by-order basis and may require prepayment or a 50% deposit with order and the balance prepaid before shipment.

Orders: Orders must be in writing. Faxed orders are acceptable. Processing of orders will not begin until a signed acknowledgment is received.

Acknowledgments: Orders are accepted, manufactured and invoiced based on written acknowledgments issued by Silver Street, Incorporated. All orders are considered correct as acknowledged. Notify Silver Street, Incorporated immediately of any order discrepancies. Acknowledged orders may not be changed or canceled without written consent from Silver Street, Incorporated.

Changes to orders: Changes to orders already in process may be subject to a fee covering the cost to make the requested change. If a fee is necessary a written authorization of acceptance will be required. All requests for changes are subject to approval by Silver Street, Incorporated.

Cancellation of orders: All orders received by Silver Street, Incorporated are considered firm and cannot be canceled without our approval. A cancellation fee may be required based upon cost incurred by Silver Street, Incorporated prior to receipt of a cancellation request.

Returns: Returns are not accepted without a Return Goods Authorization issued by Silver Street, Incorporated. Unauthorized returns will not be accepted. Returns may be subject to a restocking fee.

Shipping Terms: All orders will be shipped F.O.B. shipping point with freight charged collect. Shipping weights listed are net.

Routing: Shipments will be routed "best way" or as specified. Instructions will be followed as closely as possible, however, Silver Street, Incorporated reserves the right to make changes due to local conditions or other circumstances.

Freight Damage: Legal title to merchandise passes to the buyer upon acceptance by the carrier. All cartons must be carefully inspected at the time of delivery. Visible damage should be noted on the delivery receipt. In the case of concealed damage, the carrier must be notified within (5) days. It is the buyer's obligation to seek recourse against the shipper.

Shortages: Shipments should be inspected upon receipt for shortages. Shortages must be reported to Silver Street, Incorporated in writing within (5) days of receipt.

Shipping Address:

mediatechnologies
892 Industrial Park Drive
Shelby, MI 49455

Warranty: All items manufactured by Silver Street, Incorporated, home of mediatechnologies® and Definits by mediatechnologies are guaranteed against defects for a period of five (5) years from the date of purchase. We will repair or replace, in our discretion, any defective item without cost to our customer. This is customer's sole and exclusive remedy against us. No delay in shipment or delivery shall give rise to any liability for damages whatsoever. We are not liable for defects caused by customer or any third party. Customer is not authorized to make any repairs whatsoever or to deduct any amount from the purchase price. In no event shall our liability under this warranty exceed the purchase price. In no event shall we be liable for incidental, special or consequential damages. We disclaim all other warranties, express or implied, as to any matter whatsoever, including without limitation, quality, design, performance, specifications, samples, condition, merchantability and fitness for any particular purpose. No action may be commenced for breach of the warranty more than six months after the cause of action accrues and any such action may only be brought in the county of Oceana, State of Michigan.

definitions
by **mediatechnologies®**

is a registered trademark of Silverstreet Incorporated.

U.S. Patent # 8,434,835 B2

P-DEFINITIONSWALL-251124