



Photography by Tom Holdsworth Photography

# Drift Collection

classroom • media center







media center



# DRIFT STORAGE



classroom

# DRIFT CURVED SHELVING

## Single Faced – Wood Back



Drift Concave 30"H  
DFT-3018V  
(2) adjustable shelf on inner curve  
18"D x 72"W x 30"H



Drift Convex 30"H  
DFT-3018X  
(2) adjustable shelf on outer curve  
18"D x 72"W x 30"H



Drift Concave 36"H  
DFT-3618V  
(2) adjustable shelves on inner curve  
18"D x 72"W x 36"H



Drift Convex 36"H  
DFT-3618X  
(2) adjustable shelves on outer curve  
18"D x 72"W x 36"H



Drift Concave 42"H & 48"H  
DFT-4218V & DFT-4818V  
(4) adjustable shelves on inner curve  
18"D x 72"W x 42"H/48"H



Drift Convex  
DFT-4218X & DFT-4818X  
(4) adjustable shelves on outer curve  
18"D x 72"W x 42"H/48"H

## Single Faced – Perforated Metal Back



Steel Drift Concave 30"H  
DFTS-3018V  
(1) adjustable shelf on inner curve  
18"D x 72"W x 30"H



Drift Convex 30"H  
DFTS-3018X  
(1) adjustable shelf on outer curve  
18"D x 72"W x 30"H



Drift Concave 36"H  
DFTS-3618V  
(2) adjustable shelves on inner curve  
18"D x 72"W x 36"H



Drift Convex 36"H  
DFTS-3618X  
(2) adjustable shelves on outer curve  
18"D x 72"W x 36"H

**Note:** Some model numbers listed above are partial. Models receiving handles and connecting magnets will receive an "H". i.e. "DFTH-3018V-O-MOB".

# DRIFT CURVED SHELVING

## Single Faced - Perforated Metal Back Continued



Drift Concave 42"H/48"H  
DFTS-4218V & DFTS-4818V  
(4) adjustable shelves on inner curve  
18"D x 72"W x 42/48"H



Drift Convex 42"H/48"H  
DFTS-4218X & DFTS-4818X  
(4) adjustable shelves on outer curve  
18"D x 72"W x 42/48"H

## Double Faced – Perforated Metal Back

**Note:** Double Faced curve units come in only perforated metal back options.



Concave Side



Convex Side

Drift Double Faced 30"H & 36"H  
DFTS-3024D  
(2) adjustable shelf on each side  
24"D x 67"W x 30"H/36"H



Concave Side



Convex Side

Drift Double Faced 42"H & 48"H  
DFTS-4224D & DFTS-4824D  
(4) adjustable shelves on each side  
24"D x 67"W x 42"H/48"H

**Note:** Some model numbers listed above are partial. Models receiving handles and connecting magnets will receive an "H". i.e. "DFT**H**-3018V-O-MOB".

# DRIFT STRAIGHT SHELVING

## Single Faced – Wood Back



Drift Straight 36"H  
DFT-42-3618S-OCB  
DFT-42-3624S-OCB  
(2) adjustable shelves



Drift Straight 42"H  
DFT-42-4218S-OCB  
DFT-42-4818S-OCB  
DFT-42-4224S-OCB  
DFT-42-4824S-OCB  
(4) adjustable shelves



Drift Straight 54"H  
DFT-42-5418S-OCB  
DFT-42-5424S-OCB  
(6) adjustable shelves



Drift Straight 72"H  
DFT-42-7224S-OCB  
(8) adjustable shelves

## Single Faced – Perforated Metal Back



Steel Drift Straight 42"H & 48"H  
DFTS-42-4218S-OCB  
DFTS-42-4818S-OCB  
DFTS-42-4224S-OCB  
DFTS-42-4824S-OCB  
(4) adjustable shelves



Drift Straight  
Double Faced 36"H  
DFT-42-3624SD-OCB  
(4) adjustable shelves



Drift Straight  
Double Faced 42"H & 48"H  
DFT-42-4224SD-OCB  
DFT-42-4824SD-OCB  
(8) adjustable shelves



Drift Straight  
Double Faced 54"H  
DFT-42-5424SD-OCB  
(12) adjustable shelves

## Double Faced – Perforated Metal Back



Drift Straight  
Double Faced 36"H  
DFTS-42-3624SD-OCB  
(4) adjustable shelves



Drift Straight  
Double Faced 42"H & 48"H  
DFTS-42-4224SD-OCB  
DFTS-42-4824SD-OCB  
(8) adjustable shelves



Drift Straight  
Double Faced 54"H  
DFTS-42-5424SD-OCB  
(12) adjustable shelves

**Note:** Some model numbers listed above are partial. Models receiving handles and connecting magnets will receive an "H". i.e. "DFTH-3018V-O-MOB".



# DRIFT STORAGE

## Drift Open Tote Storage



**Drift Open Tote 36"H**  
DFT-42-3618S-TOTO-\_-MOB  
18"D x 42"W x 36"H  
24 Tote Rails



**Drift Open Tote 42"H**  
DFT-42-4218S-TOTO-\_-MOB  
18"D x 42"W x 42"H  
30 Tote Rails



**Drift Open Tote 48"H**  
DFT-42-4818S-TOTO-\_-MOB  
18"D x 42"W x 48"H  
36 Tote Rails  
*\*Totes sold separately*



**Drift Open Tote 36"H (Lego®)**  
DFTLG-42-3618S-TOTO-\_-MOB  
18"D x 42"W x 36"H  
24 Tote Rails



**Drift Open Tote 42"H (Lego®)**  
DFTLG-42-4218S-TOTO-\_-MOB  
18"D x 42"W x 42"H  
30 Tote Rails



**Drift Open Tote 48"H (Lego®)**  
DFTLG-42-4818S-TOTO-\_-MOB  
18"D x 42"W x 48"H  
36 Tote Rails  
*\*Totes sold separately*



## Available Lego® Colors



Green



Blue



Grey

**Note:** Some model numbers listed above are partial. Models receiving handles and connecting magnets will receive an "H". i.e. "DFTSH-42-3618S-TOTO-L-MOB".  
**\*Totes sold separately on all units.**

# DRIFT STORAGE

## Drift Learning Curve



**Drift Learning Curve 30"H**  
DFT-60-3018XTOT-\_-MOB  
18"D x 60"W x 30"H  
12 Tote Rails



**Drift Learning Curve 36"H**  
DFT-60-3618XTOT-\_-MOB  
18"D x 60"W x 36"H  
18 Tote Rails



**Drift Learning Curve 42"H**  
DFT-60-4218XTOT-\_-MOB  
18"D x 60"W x 42"H  
20 Tote Rails



*\*Shown with Markerboard back option*

*\*Learning Curve models not available with handles and connecting magnets.*

*\*Totes sold separately on all units.*

## Drift Open Storage – Single Faced



**Drift Open Storage 30"H**  
DFT-24-3018S-OS-\_-MOB  
DFT-24-3024S-OS-\_-MOB  
18"/24"D x 24"W x 30"H



**Drift Open Storage 36"H**  
DFT-24-3618S-OS-\_-MOB  
DFT-24-3624S-OS-\_-MOB  
DFT-36-3618S-OS-\_-MOB  
DFT-36-3624S-OS-\_-MOB  
18"/24"D x 24"/36"W x 36"H



**Drift Open Storage 42"H**  
DFT-36-4218S-OS-\_-MOB  
DFT-36-4224S-OS-\_-MOB  
18"/24"D x 36"W x 42"H

**Note:** Some model numbers listed above are partial.  
Models receiving handles and connecting magnets will receive an "H".  
i.e. "DFTSH-42-3618S-TOTO-L-MOB".



# DRIFT STORAGE

## Drift Open Storage – Single Faced



**Drift Open Storage 48"H**  
DFT-36-4818S-OS-\_-MOB  
DFT-36-4824S-OS-\_-MOB  
18"/24"D x 36"W x 48"H



**Drift Open Storage 54"H**  
DFT-36-5418S-OS-\_-MOB  
DFT-36-5424S-OS-\_-MOB  
18"/24"D x 36"W x 54"H



**Drift Open Storage 72"H**  
DFT-36-7224S-OS-\_-MOB  
24"D x 36"W x 72"H

## Drift Open Storage – Double Faced



**Drift Open Storage 36"H**  
DFT-36-3624SD-OS-\_-MOB  
24"D x 24"/34"W x 36"H



**Drift Open Storage 42"H**  
DFT-36-4224SD-OS-\_-MOB  
24"D x 36"W x 42"H



**Drift Open Storage 48"H**  
DFT-36-4824SD-OS-\_-MOB  
24"D x 36"W x 48"H



**Drift Open Storage 54"H**  
DFT-36-5424SD-OS-\_-MOB  
24"D x 36"W x 54"H

**Note:** Some model numbers listed above are partial.  
Models receiving handles and connecting magnets will receive an "H". i.e.  
"DFTSH-42-3618S-TOTO-L-MOB".

# DRIFT STORAGE

## Drift Cupboard Storage



**Drift Cupboard Storage 36"H**  
DFT-36-3618S-CS-\_-MOB  
DFT-36-3624S-CS-\_-MOB  
18"/24"D x 36"W x 36"H



**Drift Cupboard Storage 42"H**  
DFT-36-4218S-CS-\_-MOB  
DFT-36-4224S-CS-\_-MOB  
18"/24"D x 36"W x 42"H



**Drift Cupboard Storage 48"H**  
DFT-36-4818S-CS-\_-MOB  
DFT-36-4824S-CS-LL-MOB  
18"/24"D x 36"W x 48"H



**Drift Cupboard Storage 54"H**  
DFT-36-5418S-CS-\_-MOB  
DFT-36-5424S-CS-\_-MOB  
18"/24"D x 36"W x 54"H



**Drift Cupboard Storage 72"H**  
DFT-36-7224S-CS-\_-MOB  
24"D x 36"W x 72"H

**Note:** 72"H units receive 100mm casters.

**Note:** Some model numbers listed above are partial.  
Models receiving handles and connecting magnets will receive an "H".  
i.e. "DFTSH-42-3618S-TOTO-L-MOB".

# DRIFT STORAGE

## Drift Combination Storage



**Drift Open/Cupboard Storage 42"H**  
DFT-36-4218S-OCS-\_-MOB  
DFT-36-4224S-OCS-\_-MOB  
18"/24"D x 36"W x 42"H



**Drift Open/Cupboard Storage 42"H**  
DFT-36-4818S-OCS-\_-MOB  
DFT-36-4824S-OCS-\_-MOB  
18"/24"D x 36"W x 42"H

**Note:** Some model numbers listed above are partial.  
Models receiving handles and connecting magnets will receive an "H".  
i.e. "DFTSH-42-3618S-TOTO-L-MOB".

## Drift Binford – Single Faced



**Binford Single Faced 30"H**  
DFT-36-3018S-OCBBT-\_-MOB  
DFT-36-3024S-OCBBT-\_-MOB  
18"/24"D x 36"W x 30"H



**Binford Single Faced 36"H**  
DFT-36-3618S-OCBBT-\_-MOB  
DFT-36-3624S-OCBBT-\_-MOB  
18"/24"D x 36"W x 36"H



**Binford Single Faced 42"H**  
DFT-36-4218S-OCBBT-\_-MOB  
DFT-36-4224S-OCBBT-\_-MOB  
18"/24"D x 36"W x 42"H

## Drift Binford – Double Faced



**Binford Double Faced 30"H**  
DFT-36-3024D-OCBBT-L-MOB  
24"D x 36"W x 30"H



**Binford Double Faced 36"H**  
DFT-36-3624D-OCBBT-L-MOB  
24"D x 36"W x 36"H



**Binford Double Faced 42"H**  
DFT-36-4224D-OCBBT-L-MOB  
24"D x 36"W x 42"H



# DRIFT STORAGE

## Drift Ideaboard



**Drift Idea Board with Tote Storage 72"H**

DFTI-28-7220-TOT-\_-MOB  
20"D x 28"W x 72"H



**Drift Ideaboard with Open Storage 72"H**

DFTI-28-7220-OS-\_-MOB  
20"D x 28"W x 72"H

**Note:** Some model numbers listed above are partial. Models receiving Felt Tackboards will have "F1" for Group 1 Felt and "F2" for Group 2 Felt. i.e. "DFTI-28-7220-TOT-LF1-MOB". Felt options are shown on the following page.

## Drift Floating Classroom with Tote Storage



Classroom Side



Teacher Side

**38" Wide**

**Drift Floating Classroom with Tote Storage 60"H**

DFTC-38-6028D-TOT-\_-MOB  
28"D x 38"W x 60"H



Classroom Side



Teacher Side

**52" Wide**

**Drift Floating Classroom with Tote Storage 48"H**

DFTC-52-4828D-TOT-\_-MOB  
28"D x 52"W x 48"H



Classroom Side



Teacher Side

**52" Wide**

**Drift Floating Classroom with Tote Storage 60"H**

DFTC-52-6028D-TOT-\_-MOB  
28"D x 52"W x 60"H

**Note:** To specify Felt Tackboard Models add -F1 for Group 1 Felt and -F2 for Group 2 Felt. i.e. "DFTC-52-4828D-TOT-TT-MOB-F1". Felt options are shown on the following page.

**Grade I Felt:** Silver AC03, Light Grey AC10, Sesame AC12, Black AC44, Navy Blue AC42, Sky AC07, Olive AC46, Bright Yellow AC51, Orange AC32, Burgundy Red AC17, Light Tan AC05, Camel AC02

**Grade II 3form Felt:** Admiral, Jasper, Citrine, Aries, Nickel, Armor, Steel, Mineral, Cast, Ebony, Platinum, Steel Blue, Dusk, Nightfall, Emerald, Dune, Driftwood, Silt, Mustard, Ochre, Saffron

# DRIFT STORAGE

## Picturebook Shelving – Single Faced



**Drift Picture Book 42"/48"H**  
DFTS-36-4218SPB-OS-L-MOB  
DFTS-36-4818SPB-OS-L-MOB  
18"D x 36"W x 42"H/48"H

## Picturebook Shelving – Double Faced



**Drift Picture Book 42"/48"H**  
DFT-36-4224SDPB-OS-L-MOB  
DFT-36-4824SDPB-OS-L-MOB  
24"D x 36"W x 42"H/48"H

**Note:** Some model numbers listed above are partial. Models receiving handles and connecting magnets will receive an "H". i.e. "DFTSH-36-4218SPB-OS-L-MOB".

## Felt Options for Floating Classroom & Ideaboard

### Group I – MT Standard Acoustic Felt



Silver  
AC03



Light Grey  
AC10



Sesame  
AC12



Black  
AC44



Navy Blue  
AC42



Sky  
AC07

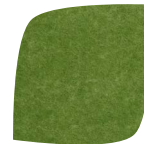

Olive  
AC46



Bright Yellow  
AC51

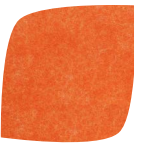

Orange  
AC32

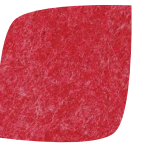

Burgundy Red  
AC17



Light Tan  
AC05



Camel  
AC02

### Group II – 3form Felt



Admiral



Jasper



Citrine



Aries



Nickel



Armor



Steel



Mineral



Steel Blue



Dusk



Nightfall



Emerald



Dune



Driftwood

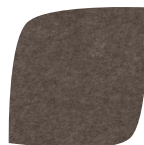

Silt



Mustard



# PRODUCT PAIRINGS & KITS

## Drift Blox Kit

- Ⓐ (3) Drift Convex Mobile Shelves – DFTS-4218X-L-MOB
- Ⓑ (3) 17"H ABLOX – ABLOX-60-5418-17
- Ⓒ (3) 9"H ABLOX – ABLOX-60-3618-9
- Ⓓ (1) CBLOX – CBLOX-36-2

Footprint as shown is  
7.5'D x 12'W

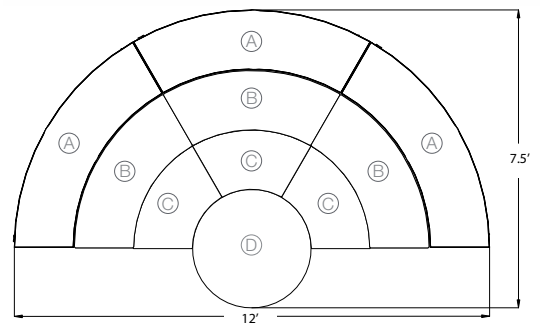
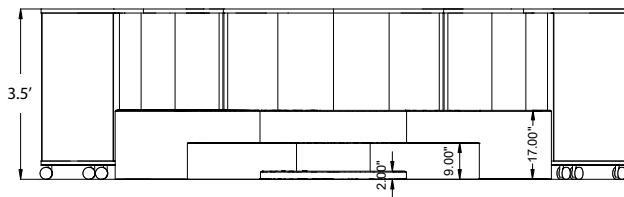
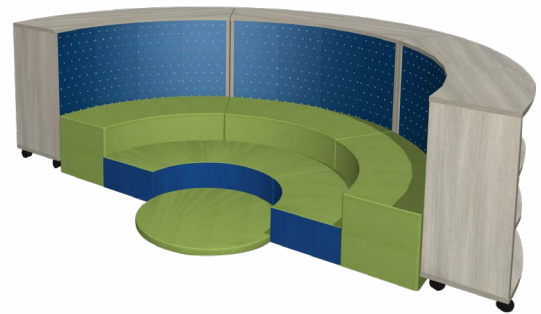

## Drift & Full Time Kit

- Ⓐ (2) Drift Convex Mobile Shelves – DFTSH-4818X-MOB
- Ⓑ (2) Full Time Halfback Curves – FTGBV2-60-5S
- Ⓒ (1) Full Time Ottobles – FTDT-0036-5D

Kit Footprint as Shown:  
7.4'D x 10.4'W

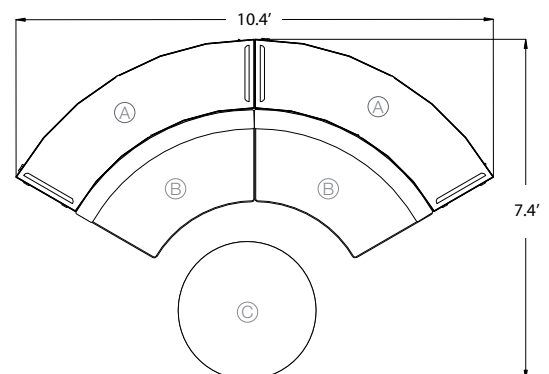
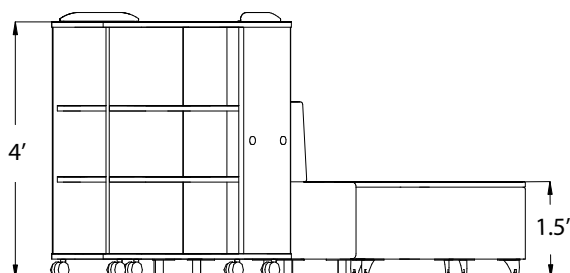



# Features & Benefits (Shelving):



- Drift Single- and Double-Faced Curved & Straight Mobile Shelving.
- Concave units have the shelving on the inside curve, convex units have the shelving on the outside curve and double sided units have shelving on both sides
- Perforated steel back options available
- Multiple configurations available when pairing together: pair concave units to make a circle or concave units with convex units to create an "S"
- Great for dividing a space or carving out a seating nook when paired with our Full Time Curve Ottomans.
- Optional connecting magnets and top handles are also available.
- View our Drift Curved Bookcase Product Demo video to learn how to adjust shelves at: <https://www.youtube.com/watch?v=7ZidtCdVYRA>

## To Order Specify

**Veneer/Thermally Fused Laminate/High Pressure Laminate:** Choose from our selection of high pressure laminates, veneer or thermally fused laminates on our website. View our Finish & Color Guide for Color Match suggestions at <https://www.mediatechnologies.com/resources/downloads/guides>

**PVC (for TFL & HPL models only):** Choose from our wide selection of PVCs. View our Finish & Color Guide for Color Match suggestions at <https://www.mediatechnologies.com/resources/downloads/guides>

**Group I Powder Coat (if applicable):** 809 Silver, 138 White, 109 Cream, 208 Putty, 304 Dove Grey, 407 Stone, 912 Black, 902 Black Wrinkle

**Group II Powder Coat (up-charge, if applicable):** 5003 Navy, 808 Nickel, 405 Charcoal, 621 Goldfinch, 622 Parakeet, 613 Blue Heron, 627 Blue Wren, 629 Hummingbird, 618 Purple Martin, 624 Cardinal

See **mediatechnologie's** finish choices at <https://www.mediatechnologies.com/resources/finishes>

## Model Number Breakdown:

[DFT][S][H]-[3018][V]-[O]-[MOB]

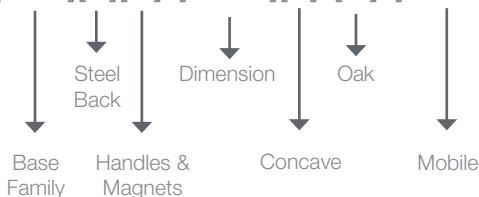

Concave      Convex  
Concave unit has shelving on inside curve.  
Convex unit has shelving on outside curve.

## Options



Handles



Connecting Magnets



Steel Bumpouts  
DFT-CSBX-6

**Note:** Handles and Connecting Magnets are sold as a package and are specified with an "H" in the model number. i.e. "DFT-3018V-O-MOB"

**Note:** Steel bumpouts are designated with their own model number. DFT-CSBV-6 for concave units and DFT-CSBX-6 for convex units.

# Features & Benefits (Storage):



- Various storage options including: cabinet, combination, tote & open storage
- Wood, Steel or Markerboard back
- Adjustable shelves
- Optional handles and connecting magnets
- 2" diameter casters are standard
- View our Drift Curved Bookcase Product Demo video to learn how to adjust shelves at:  
<https://www.youtube.com/watch?v=7ZidtCdVYRA>

## To Order Specify

**Thermally Fused Laminate/High Pressure Laminate:** Choose from our selection of high pressure laminates or thermally fused laminates on our website. View our Finish & Color Guide for Color Match suggestions at <https://www.mediatechnologies.com/resources/downloads/guides>

**PVC:** Choose from our wide selection of PVCs. View our Finish & Color Guide for Color Match suggestions at <https://www.mediatechnologies.com/resources/downloads/guides>

**Group I Powder Coat (if applicable):** 809 Silver, 138 White, 109 Cream, 208 Putty, 304 Dove Grey, 407 Stone, 912 Black, 902 Black Wrinkle

**Group II Powder Coat (up-charge, if applicable):** 5003 Navy, 808 Nickel, 405 Charcoal, 621 Goldfinch, 622 Parakeet, 613 Blue Heron, 627 Blue Wren, 629 Hummingbird, 618 Purple Martin, 624 Cardinal

**Lego Color (if applicable):** Green, Blue, Grey

**Grade I Felt (if applicable):** Silver AC03, Light Grey AC10, Sesame AC12, Black AC44, Navy Blue AC42, Sky AC07, Olive AC46, Bright Yellow AC51, Orange AC32, Burgundy Red AC17, Light Tan AC05, Camel AC02

**Grade II 3form Felt (if applicable):** Admiral, Jasper, Citrine, Aries, Nickel, Armor, Steel, Mineral, Cast, Ebony, Platinum, Steel Blue, Dusk, Nightfall, Emerald, Dune, Driftwood, Silt, Mustard, Ochre, Saffron

See mediatechnologies' finish selections at <https://www.mediatechnologies.com/resources/finishes>

## Model Number Breakdown

[DFTS]-[42]-[3618][S]-[TOTO]-[L]-[MOB]

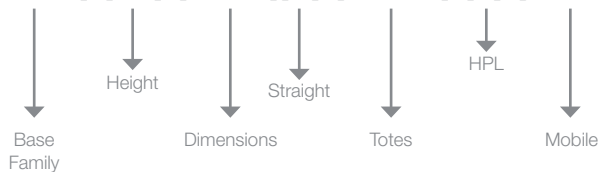

## Options

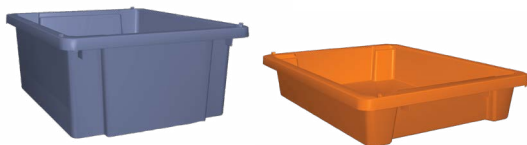

TOTO Totes  
TOT03  
TOT06



Handles



Connecting  
Magnets

**Note:** Handles and Connecting Magnets are sold as a package and are specified with an "H" in the model number. i.e. "DFTH-3018V-O-MOB"



# Drift Harbor Desk

media center • innovation center • wellness center











# DRIFT HARBOR DESK

## Desk Units



DHRB-3624S-30-D



DHRB-4824S-30-D



DHRB-6024S-30-D



DHRB-7224S-30-D



DHRB-7824V-30-D

## Desk Units with Transaction Tops



DHRB-3624S-30-D-TRX



DHRB-4824S-30-D-TRX



DHRB-6024S-30-D-TRX



DHRB-7224S-30-D-TRX



DHRB-7824V-30-D-TRX  
(User Side)



DHRB-7824V-30-D-TRX  
(Patron Side)



# DRIFT HARBOR DESK

## Desk Units (ADA)



DHRB-3624S-30-ADA  
(User side)



DHRB-3624S-30-ADA



DHRB-4824S-30-ADA  
(User side)



DHRB-4824S-30-ADA

## Book Return



DHRB-3624S-30-BR  
(Shown with 18\"D Descending  
Platform Booktruck  
MCD-DBTL-1824-24)



DHRB-3624S-30-BR  
(Patron Side)

## Cupboard Storage



DHRB-2424S-30-CS-P2N



DHRB-3624S-30-CS-P2N

## Open Storage



DHRB-2424S-30-OS



DHRB-2424S-30-OS  
(Patron side)



DHRB-3624S-30-OS



DHRB-2424RC-30-OS

## Tote Storage



DHRB-2424S-30-TOT-T01  
\*with translucent totes



DHRB-3624S-30-TOT-T01  
\*with translucent totes

## Non-Handed Steel End Panel



DHRB-24-30-TEP

# DRIFT HARBOR CORNER KIT

## Drift Harbor Corner V1 (DHRB-CRNR-V1)

- (A) (1) DHRB-4824S-30-D
- (B) (1) DHRB-2424S-30-OS
- (C) (1) DHRB-3624S-30-BR
- (D) (1) MCD-DBTL-1824-24
- (E) (1) DHRB-2424RC-30-OS
- (F) (1) DHRB-3624S-30-ADA
- (G) (2) DHRB-24-30-TEP



DHRB-CRNR-V1  
(Patron Side)



DHRB-CRNR-V1  
(User Side)

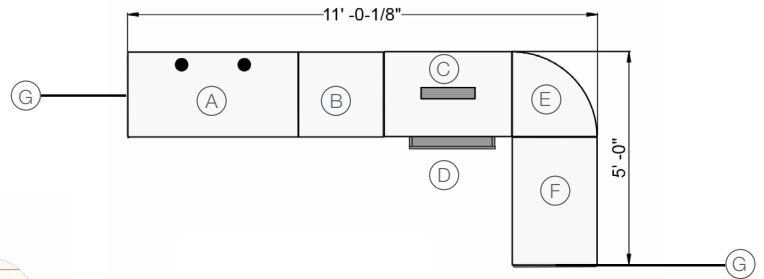

## Drift Harbor Corner V2 (DHRB-CRNR-V2)

- (A) (2) DHRB-4824S-30-D-TRX
- (B) (1) DHRB-3624S-30-OS
- (C) (1) DHRB-3624S-30-BR
- (D) (1) MCD-DBTL-1824-24
- (E) (2) DHRB-2424RC-30-OS
- (F) (1) DHRB-4824S-30-ADA
- (G) (2) DHRB-24-30-TEP



DHRB-CRNR-V2  
(Patron Side)



DHRB-CRNR-V2  
(User Side)

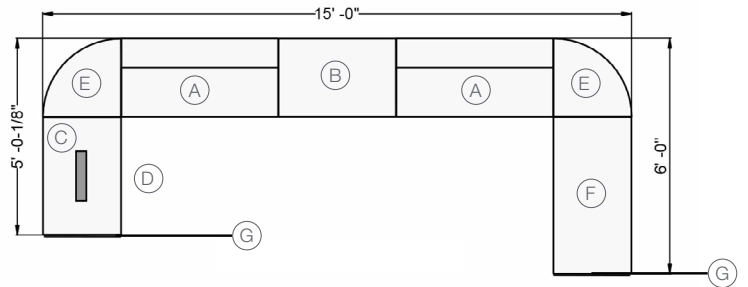

## Drift Harbor Corner V3 (DHRB-CRNR-V3)

- (A) (1) DHRB-3624S-30-CS-P2N
- (B) (1) DHRB-4824S-30-D
- (C) (2) DHRB-2424RC-30-OS
- (D) (1) DHRB-7224S-30-D-TRX
- (E) (1) DHRB-3624S-30-BR
- (F) (1) MCD-DBTL-1824-24
- (G) (1) DHRB-2424S-30-TOT-T01
- (H) (2) DHRB-24-30-TEP



DHRB-CRNR-V3  
(Patron Side)



DHRB-CRNR-V3  
(User Side)

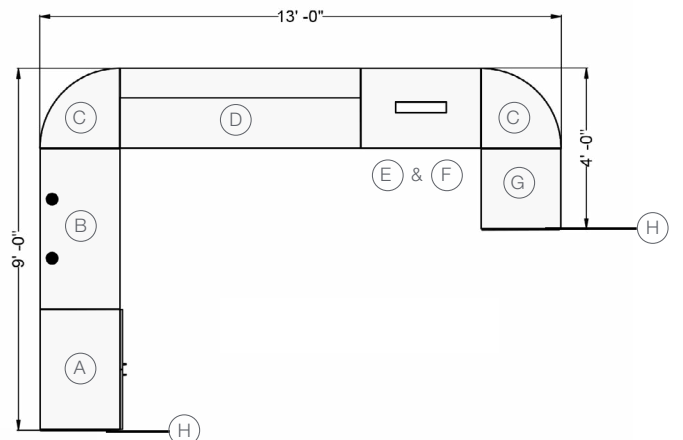

# DRIFT HARBOR COVE KIT

## Drift Harbor Cove V1 (DHRB-COVE-V1)

- (A) (2) DHRB-7824V-30-D-TRX
- (B) (1) DHRB-2424S-30-TOT-T01
- (C) (1) DHRB-2424S-30-OS
- (D) (2) DHRB-24-30-TEP
- (E) (1) DHRB-3624S-30-BR
- (F) (1) MCD-DBTL-1824-24

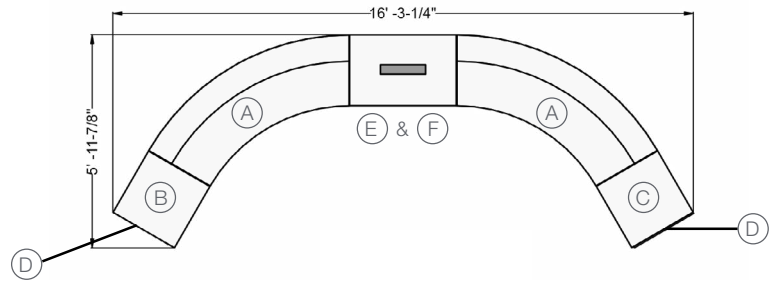

DHRB-COVE-V1  
(Patron Side)



DHRB-COVE-V1  
(User Side)

## Drift Harbor Cove V2 (DHRB-COVE-V2)

- (A) (2) DHRB-7824V-30-D-TRX
- (B) (1) DHRB-2424S-30-TOT-T01
- (C) (1) DHRB-2424S-30-CS-P2N
- (D) (2) DHRB-24-30-TEP
- (E) (1) DHRB-3624S-30-TOT-T01

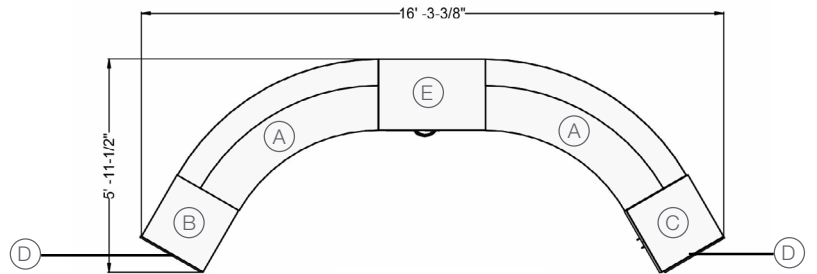

DHRB-COVE-V2  
(Patron Side)



DHRB-COVE-V2  
(User Side)

## Drift Harbor Cove V3 (DHRB-COVE-V3)

- (A) (2) DHRB-7824V-30-D-TRX
- (B) (2) DHRB-2424S-30-CS-P2N
- (C) (1) DHRB-3624S-30-ADA
- (D) (2) DHRB-24-30-TEP

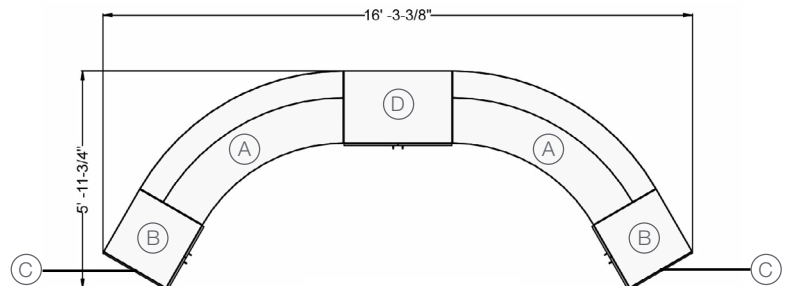

DHRB-COVE-V3  
(Patron Side)



DHRB-COVE-V3  
(User Side)

# DRIFT HARBOR CURVE KIT

## Drift Harbor Curve V1 (DHRB-CRV-V1)

- (A) (2) DHRB-7824V-30-D-TRX
- (B) (1) DHRB-7824V-30-D
- (C) (2) DHRB-24-30-TEP
- (D) (2) WHPS61218-W-LL-P2N

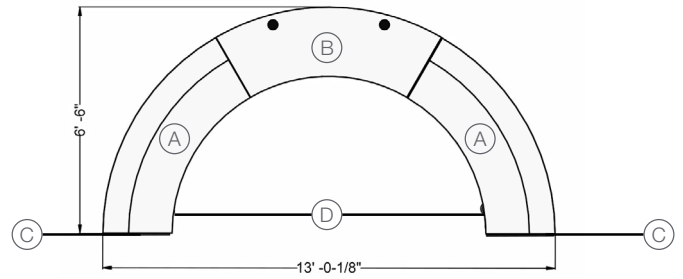

DHRB-CRV-V1  
(Patron Side)



DHRB-CRV-V1  
(User Side)

## Drift Harbor Curve V2 (DHRB-CRV-V2)

- (A) (1) DHRB-7824V-30-D-TRX
- (B) (1) DHRB-7824V-30-D-30
- (C) (2) DHRB-24-30-TEP
- (D) (1) WHPS61218-W-LL-P2N
- (E) (1) DHRB-2424S-CS-30-P2N

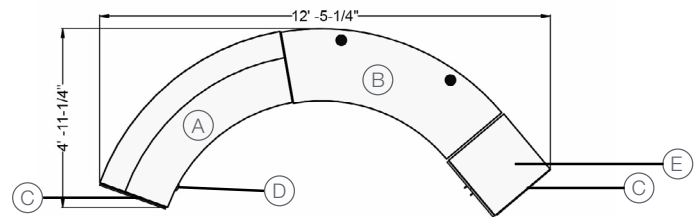

DHRB-CRV-V2  
(Patron Side)



DHRB-CRV-V2  
(User Side)

## Drift Harbor Curve V3 (DHRB-CRV-V3)

- (A) (1) DHRB-7824V-30-D-TRX
- (B) (1) DHRB-7824V-30-D
- (C) (2) DHRB-24-30-TEP
- (D) (1) WHPS61218-W-LL-P2N
- (E) (1) DHRB-3624S-30-BR
- (F) (1) MCD-DBTL-1824-24

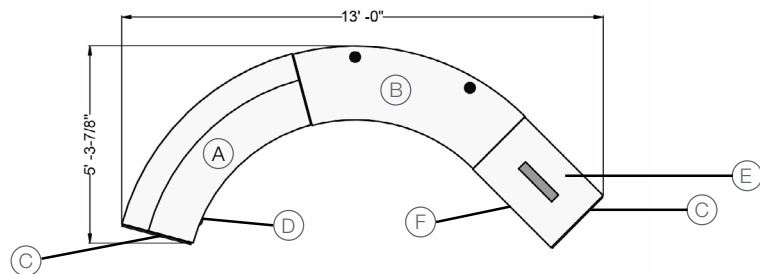

DHRB-CRV-V3  
(Patron Side)



DHRB-CRV-V3  
(User Side)



# DRIFT HARBOR CURVE KIT

## Magnetic Logo Options:



12" Dia. (Round)



18" Dia. (Round)



12" x 12" (Square)



18" x 18" (Square)



12"H x 36"W (Rectangle)



16"H x 48"W (Rectangle)

# Features & Benefits:



- High pressure laminate work surfaces and transaction tops with 3mm PVC edges
- High pressure laminate end and intermediate panels with 3mm PVC edges
- Rare Earth magnets on end panels for ganging desk units
- 60mm dual grommet is standard for wire passage in end panels
- Open Desk units include 60mm grommets in the top for wire passage
- 75mm locking casters towards the patron side of the desk and adjustable height levelers on the bottom of the vertical panels towards the user side
- 18-gauge powder coated steel back panel
- Tote storage includes thermoplastic rails to organize and store our full range of totes. **Note:** Tote rails are Falcon T15 thermoplastic
- 16-gauge powder coated steel terminating end panels attach to the magnets on the side of the desk

## To Order Specify

**High Pressure Laminate:** Choose from our selection of high pressure laminates on our website. View our Finish & Color Guide for Color Match suggestions at <https://www.mediatechnologies.com/resources/downloads/guides>

**PVC:** Choose from our wide selection of PVCs. View our Finish & Color Guide for Color Match suggestions at <https://www.mediatechnologies.com/resources/downloads/guides>

**Group I Powder Coats:** 809 Silver, 138 White, 109 Cream, 304 Dove Grey, 208 Putty, 407 Stone, 903 Black Wrinkle, 912 Black

**Group II Powder Coats (up-charge):** 808 Nickel, 405 Charcoal, 5003 Navy, MIR Mirrored Chrome, 621 Goldfinch, 622 Parakeet, 613 Blue Heron, 627 Blue Wren, 629 Hummingbird, 618 Purple Martin, 624 Cardinal, 623 Oriole

See **mediatechnologie's** finish choices at <https://www.mediatechnologies.com/resources/finishes>

## Model Number Breakdown:

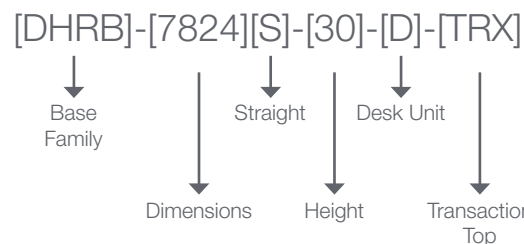

## Logo Magnets



DHRB-MAGLOGO-1648

## Options



Pencil Drawer  
MCD1817

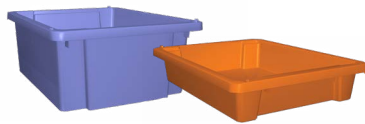

Toto Totes  
TOT03 - 3" Totes  
TOT06 - 6" Totes

## Connectivity (for 80mm grommets)



Jolt  
AJLT-2P1U1C1O-\_B



Port  
APRT-1P1U1C-\_B



892 Industrial Park Drive  
Shelby, MI 49455  
P: 231.861.2194  
sales@mediatechnologies.com



cs-Drift-Harbor-250703

# DRIFT TABLE

---

## Tables

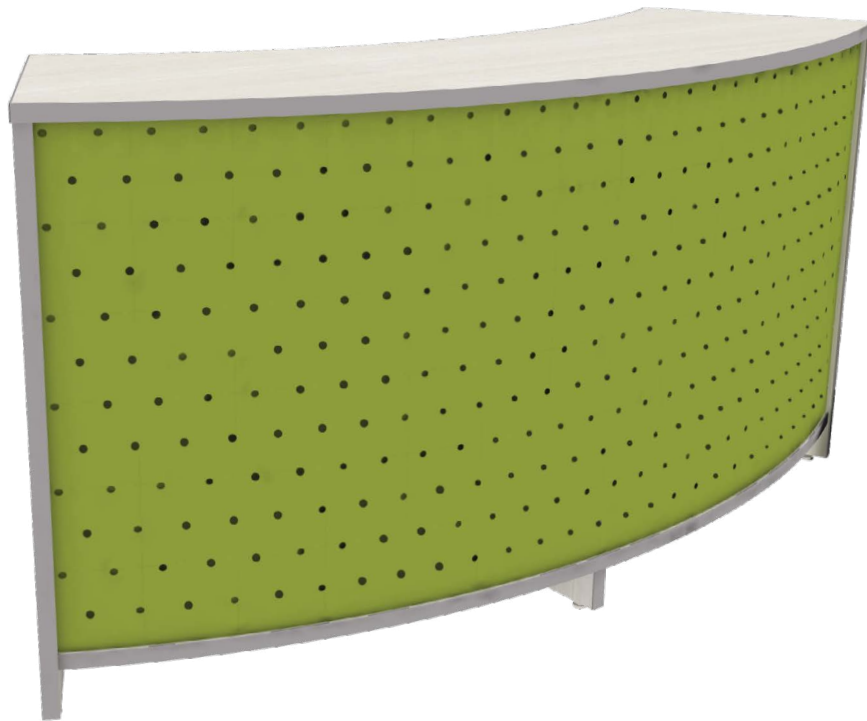

DFTT-C1872-60CRV-36

18"D x 72"W x 36"H

# DRIFT TABLE

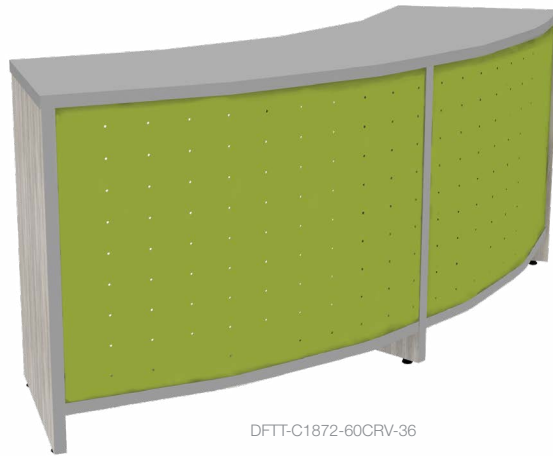

DFTT-C1872-60CRV-36

## DRIFT TABLE

- Works seamlessly with the aesthetic of our Drift Shelving.
- Available in convex and concave options.
- Work surface is high pressure laminate.
- Available in high pressure laminate or thermally fused laminate case.

### DRIFT TABLE STANDARD SIZES

MODEL	DEPTH"	WIDTH"	HEIGHT"
DFTTS-2472V-_-_-	24	72	30, 36, 42
DFTTS-2472X-_-_-	24	72	30, 36, 42
DFTTS-2448-_-_-	24	48	30, 36, 42
DFTTS-2460-_-_-	24	60	30, 36, 42

#### General Specifications (HPL)

**End/Intermediate Panels:** All end and intermediate panels are un-detailed 1" engineered wood with high pressure laminate on both faces; exposed edges are banded with 3mm PVC with edges and corners radiused 1/8".

**Top:** The top panel is 1" thick engineered with high pressure laminate faces. The edges are banded with 3mm PVC. The top is attached to the vertical panels using dowel and cam connections. The back edge of the panel is dadoed to contain the curved back panel (if 1/4" engineered wood back option is chosen).

**Base:** The base is a structural 1" thick engineered wood with a high pressure laminate face and a .030 phenolic backer; exposed edges are banded with 3mm PVC with edges and corners radiused 1/8". The base is attached to the vertical panels using dowel and cam connections. The back edge of the panel is dadoed to contain the curved back panel (if 1/4" engineered wood back option is chosen).

**Back Panel:** Engineered wood backs are 1/4" thick with high pressure laminate on both faces (DFTT) or curved 18-gauge perforated powder coated steel panel (DFTTS).

### To Order, Choose Finish Selections & Options

**Work Surface:** Choose from our selection of high pressure laminates.

**End/Intermediate Panels:** Choose from our selection of high pressure laminates or thermally fused laminates.

**Base:** Choose from our selection of high pressure laminates or thermally fused laminates.

See **mediatechnologies'** finish choices at <https://www.mediatechnologies.com/resources/finishes>

#### General Specifications (TFL)

**End/Intermediate Panels:** All end and intermediate panels are un-detailed 1" engineered wood with thermally fused laminate on both faces; exposed edges are banded with 3mm PVC with edges and corners radiused 1/8".

**Top:** The top panel is 1" thick engineered with thermally fused laminate faces. The edges are banded with 3mm PVC. The top is attached to the vertical panels using dowel and cam connections. The back edge of the panel is dadoed to contain the curved back panel (if 1/4" engineered wood back option is chosen).

**Base:** The base is a structural 1" thick engineered wood with thermally fused laminate faces; exposed edges are banded with 3mm PVC with edges and corners radiused 1/8". The base is attached to the vertical panels using dowel and cam connections. The back edge of the panel is dadoed to contain the curved back panel (if 1/4" engineered wood back option is chosen).

**Back Panel:** Engineered wood backs are 1/4" thick with high pressure laminate on both faces (DFTT) or curved 18-gauge perforated powder coated steel panel (DFTTS).



cs-drifttables-240109

892 Industrial Park Drive  
Shelby, MI 49455  
P: 231.861.2194  
F: 231.861.6678  
[www.mediatechnologies.com](http://www.mediatechnologies.com)  
[sales@mediatechnologies.com](mailto:sales@mediatechnologies.com)

PURE MICHIGAN®



# DRIFT

---

## Benches



DFTB-42-1819-TOTO-L-MOB

19"D X 42"W X 18"H

# DRIFT



DFTB-42-1819-TOTO-L-MOB

## DRIFT BENCH

- Available in two storage base options: Open Storage and Open Tote Storage. Storage base is only available on one side.
- Pairs with Drift mobile shelving and storage.
- Comfortable 1-1/2" thick upholstered seat cushion.
- Available in your choice of oak or maple veneer, high-pressure laminate or melamine.
- Swivel casters for added mobility.

### DRIFT BENCH OPEN STORAGE STANDARD SIZES

MODEL	DEPTH"	WIDTH"	HEIGHT"
DFTB-42-1819-OS-T-MOB	19	42	18
DFTB-42-1819-OS-L-MOB	19	42	18
DFTB-42-1819-OS-M-MOB	19	42	18
DFTB-42-1819-OS-O-MOB	19	42	18

#### General Specifications

**End/Intermediate Panels:** All end and intermediate panels are un-detailed 3/4" engineered wood with high pressure laminate, melamine or veneer on both faces; exposed laminate panel edges are banded with 3mm PVC, veneer panel edges are banded with 1/8" w wood banding. Edges and corners radiused 1/8". Vertical panels are machined for the mounting of tote rails on Open Tote Storage units. One (1) mobile storage unit is constructed of two (2) end panels and one (1) or two (2) intermediate panels. The Open Storage model has two storage compartments divided by one vertical intermediate panel. Each compartment will have one adjustable shelf. The Open Tote Storage model has three compartments with two vertical dividers.

**Top:** The top panel is 1" thick engineered wood with high pressure laminate, melamine or veneer faces. The laminate panel edges are banded with 3mm PVC, veneer panel edges are banded with 1/8" w wood banding. The top is attached with pre-glued dowels. The upholstered seat cushion assembly is 1-1/2" of upholstery foam on a 3/4" cushion backer. The seat cushion assembly is fastened to the top panel with screws.

### To Order, Choose Finish Selections & Options

**Base Cabinet:** Choose from our selection of oak or maple veneers, high pressure laminate or melamine.

**Edges:** Choose from our selection of wood or PVC edges.

**Seat:** Choose from our selection of graded fabrics.

See **mediatechnologies'** finish selections at  
<https://www.mediatechnologies.com/resources/finishes>  
View our fabric choices at  
<https://www.mediatechnologies.com/resources/fabrics>

### DRIFT BENCH OPEN TOTE STORAGE STANDARD SIZES

MODEL	DEPTH"	WIDTH"	HEIGHT"
DFTB-42-1819-TOTO-T-MOB	19	42	18
DFTB-42-1819-TOTO-L-MOB	19	42	18
DFTB-42-1819-TOTO-M-MOB	19	42	18
DFTB-42-1819-TOTO-O-MOB	19	42	18

**Base:** The base is 1" thick engineered wood with a high pressure laminate, melamine or veneer face and a .030 phenolic backer; exposed laminate panel edges are banded with 3mm PVC, veneer panel edges are banded with 1/8" w wood banding. Edges and corners radiused 1/8". The base is fastened to the vertical panels with pre-glued dowels and screws. 75mm locking swivel casters with thermoplastic elastomer treads are bolted to the bottom of the base using 5/16" - 18 machine bolts. Casters are located at the four corners of the base.

**Back Panel:** Back is 3/4" thick engineered wood with a high pressure laminate, melamine or veneer faces.

**Tote Rails (on Open Tote Storage Models):** TOTR tote rails are mounted on the inside faces of the end panels and both faces of the intermediate panels and allow totes to be fully removable. Tote rail type and spacing is suitable for the use of TOT03- & TOT06- totes. Totes are not included and can be found at:  
<https://www.mediatechnologies.com/product/totes>

*Note: DRIFT BENCHES models ship assembled.*



cs-driftbench-221227

892 Industrial Park Drive  
Shelby, MI 49455  
P: 231.861.2194  
F: 231.861.6678  
[www.mediatechnologies.com](http://www.mediatechnologies.com)  
[sales@mediatechnologies.com](mailto:sales@mediatechnologies.com)

PURE MICHIGAN®