

PLEASE NOTE: The prices below are for reference only and are base models constructed of HPL work surfaces, TFL cabinets and doors with standard pulls, standard hinges and without locks. For detailed pricing please contact your local dealer or **mediatechnologies®**.

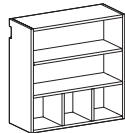

- 2 adjustable shelves

Wall Open Storage (WOS)					
Melamine			High-Pressure Laminate		
Description	Wgt.	Model Number	List Price	Model Number	List Price
18"W x 14"D x 24"H	36	WOS-181424-T	\$503	WOS-181424-L	\$698
18"W x 14"D x 30"H	39	WOS-181430-T	\$506	WOS-181430-L	\$726
24"W x 14"D x 24"H	44	WOS-241424-T	\$509	WOS-241424-L	\$728
24"W x 14"D x 30"H	47	WOS-241430-T	\$522	WOS-241430-L	\$753
30"W x 14"D x 24"H	52	WOS-301424-T	\$552	WOS-301424-L	\$827
30"W x 14"D x 30"H	55	WOS-301430-T	\$560	WOS-301430-L	\$854
36"W x 14"D x 24"H	59	WOS-361424-T	\$604	WOS-361424-L	\$984
36"W x 14"D x 30"H	63	WOS-361430-T	\$626	WOS-361430-L	\$1,006
42"W x 14"D x 24"H	73	WOS-421424-T	\$698	WOS-421424-L	\$1,096
42"W x 14"D x 30"H	78	WOS-421430-T	\$716	WOS-421430-L	\$1,136



- 1 adjustable shelf
- 18" & 24" W units will have 2 lower cubbies
- 30" & 36" W will have 3 lower cubbies

Wall Open Storage with Cubicle Storage (WOSCB3)					
Melamine			High-Pressure Laminate		
Description	Wgt.	Model Number	List Price	Model Number	List Price
18"W x 14"D x 30"H	39	WOSCB3-181430-T	\$547	WOSCB3-181430-L	\$806
24"W x 14"D x 30"H	47	WOSCB3-241430-T	\$557	WOSCB3-241430-L	\$837
30"W x 14"D x 30"H	58	WOSCB3-301430-T	\$581	WOSCB3-301430-L	\$888
36"W x 14"D x 30"H	67	WOSCB3-361430-T	\$667	WOSCB3-361430-L	\$1,094
42"W x 14"D x 30"H	82	WOSCB3-421430-T	\$802	WOSCB3-421430-L	\$1,343



- 2 adjustable shelves

Wall Cupboard Storage (WCS)					
Melamine			High-Pressure Laminate		
Description	Wgt.	Model Number	List Price	Model Number	List Price
24"W x 14"D x 24"H	58	WCS-241424-TT-H?P?N	\$794	WCS-241424-LL-H?P?N	\$1,086
24"W x 14"D x 30"H	64	WCS-241430-TT-H?P?N	\$832	WCS-241430-LL-H?P?N	\$1,174
30"W x 14"D x 24"H	68	WCS-301424-TT-H?P?N	\$884	WCS-301424-LL-H?P?N	\$1,258
30"W x 14"D x 30"H	76	WCS-301430-TT-H?P?N	\$925	WCS-301430-LL-H?P?N	\$1,343
36"W x 14"D x 24"H	79	WCS-361424-TT-H?P?N	\$972	WCS-361424-LL-H?P?N	\$1,468
36"W x 14"D x 30"H	88	WCS-361430-TT-H?P?N	\$1,014	WCS-361430-LL-H?P?N	\$1,557
42"W x 14"D x 24"H	96	WCS-421424-TT-H?P?N	\$1,073	WCS-421424-LL-H?P?N	\$1,661
42"W x 14"D x 30"H	111	WCS-421430-TT-H?P?N	\$1,137	WCS-421430-LL-H?P?N	\$1,799



- 1 door hinged left
- 2 adjustable shelves

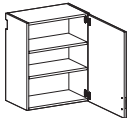

- 1 door hinged right
- 2 adjustable shelves

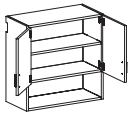

- 1 adjustable shelf

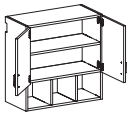

- 1 adjustable shelf
- 24" W units will have 2 lower cubbies
- 30" & 36" W units will have 3 lower cubbies

## Wall Cupboard Storage Hinged Left (WCSL)

Melamine				High-Pressure Laminate	
Description	Wgt.	Model Number	List Price	Model Number	List Price
18"W x 14"D x 24"H	45	WCSL-181424-TT-H?P?N	\$659	WCSL-181424-LL-H?P?N	\$941
18"W x 14"D x 30"H	51	WCSL-181430-TT-H?P?N	\$694	WCSL-181430-LL-H?P?N	\$1,023
24"W x 14"D x 24"H	57	WCSL-241424-TT-H?P?N	\$708	WCSL-241424-LL-H?P?N	\$1,003
24"W x 14"D x 30"H	64	WCSL-241430-TT-H?P?N	\$832	WCSL-241430-LL-H?P?N	\$1,087

## Wall Cupboard Storage Hinged Right (WCSR)

Melamine				High-Pressure Laminate	
Description	Wgt.	Model Number	List Price	Model Number	List Price
18"W x 14"D x 24"H	45	WCSR-181424-TT-H?P?N	\$659	WCSR-181424-LL-H?P?N	\$941
18"W x 14"D x 30"H	51	WCSR-181430-TT-H?P?N	\$694	WCSR-181430-LL-H?P?N	\$1,023
24"W x 14"D x 24"H	57	WCSR-241424-TT-H?P?N	\$708	WCSR-241424-LL-H?P?N	\$1,003
			\$832	WCSR-241430-LL-H?P?N	\$1,087
24"W x 14"D x 30"H	64	WCSR-241430-TT-H?P?N			

## Wall Cupboard Storage with Open Storage (WCSOS)

Melamine				High-Pressure Laminate	
Description	Wgt.	Model Number	List Price	Model Number	List Price
24"W x 14"D x 24"H	58	WCSOS-241424-TT-H?P?N	\$899	WCSOS-241424-LL-H?P?N	\$1,201
24"W x 14"D x 30"H	64	WCSOS-241430-TT-H?P?N	\$949	WCSOS-241430-LL-H?P?N	\$1,291
30"W x 14"D x 24"H	68	WCSOS-301424-TT-H?P?N	\$1,003	WCSOS-301424-LL-H?P?N	\$1,378
30"W x 14"D x 30"H	76	WCSOS-301430-TT-H?P?N	\$1,045	WCSOS-301430-LL-H?P?N	\$1,462
36"W x 14"D x 24"H	79	WCSOS-361424-TT-H?P?N	\$1,095	WCSOS-361424-LL-H?P?N	\$1,588
36"W x 14"D x 30"H	88	WCSOS-361430-TT-H?P?N	\$1,136	WCSOS-361430-LL-H?P?N	\$1,673
42"W x 14"D x 24"H	100	WCSOS-421424-TT-H?P?N	\$1,188	WCSOS-421424-LL-H?P?N	\$1,777
42"W x 14"D x 30"H	111	WCSOS-421430-TT-H?P?N	\$1,249	WCSOS-421430-LL-H?P?N	\$1,944

## Wall Cupboard Storage with Open Cubicle Storage (WCSOCB3)

Melamine				High-Pressure Laminate	
Description	Wgt.	Model Number	List Price	Model Number	List Price
24"W x 14"D x 30"H	72	WCSOCB3-241430-TT-H?P?N	\$1,154	WCSOCB3-241430-LL-H?P?N	\$1,224
30"W x 14"D x 30"H	79	WCSOCB3-301430-TT-H?P?N	\$1,280	WCSOCB3-301430-LL-H?P?N	\$1,394
36"W x 14"D x 30"H	92	WCSOCB3-361430-TT-H?P?N	\$1,392	WCSOCB3-361430-LL-H?P?N	\$1,607

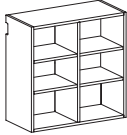

- 1 fixed partition
- 4 adjustable shelves

Wall Cubicle Storage - 6 Cubicles (WOCB6)					
Melamine			High-Pressure Laminate		
Description	Wgt.	Model Number	List Price	Model Number	List Price
18"W x 14"D x 24"H	38	WOCB6-181424-T	\$547	WOCB6-181424-L	\$801
18"W x 14"D x 30"H	41	WOCB6-181430-T	\$580	WOCB6-181430-L	\$879
24"W x 14"D x 24"H	47	WOCB6-241424-T	\$557	WOCB6-241424-L	\$827
24"W x 14"D x 30"H	50	WOCB6-241430-T	\$594	WOCB6-241430-L	\$907
30"W x 14"D x 24"H	55	WOCB6-301424-T	\$638	WOCB6-301424-L	\$969
30"W x 14"D x 30"H	58	WOCB6-301430-T	\$670	WOCB6-301430-L	\$1,044
36"W x 14"D x 24"H	64	WOCB6-361424-T	\$705	WOCB6-361424-L	\$1,123
36"W x 14"D x 30"H	67	WOCB6-361430-T	\$730	WOCB6-361430-L	\$1,195
42"W x 14"D x 24"H	78	WOCB6-421424-T	\$716	WOCB6-421424-L	\$1,138
42"W x 14"D x 30"H	82	WOCB6-421430-T	\$750	WOCB6-421430-L	\$1,215
48"W x 14"D x 24"H	87	WOCB6-481424-T	\$719	WOCB6-481424-L	\$1,138
48"W x 14"D x 30"H	92	WOCB6-481430-T	\$751	WOCB6-481430-L	\$1,216

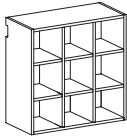

- 2 fixed vertical partitions
- 6 adjustable shelves

Wall Cubicle Storage - 9 Cubicles (WOCB9)					
Melamine			High-Pressure Laminate		
Description	Wgt.	Model Number	List Price	Model Number	List Price
18"W x 14"D x 24"H	41	WOCB9-181424-T	\$549	WOCB9-181424-L	\$802
18"W x 14"D x 30"H	44	WOCB9-181430-T	\$581	WOCB9-181430-L	\$880
24"W x 14"D x 24"H	52	WOCB9-241424-T	\$560	WOCB9-241424-L	\$828
24"W x 14"D x 30"H	55	WOCB9-241430-T	\$595	WOCB9-241430-L	\$908
30"W x 14"D x 24"H	62	WOCB9-301424-T	\$640	WOCB9-301424-L	\$970
30"W x 14"D x 30"H	65	WOCB9-301430-T	\$672	WOCB9-301430-L	\$1,048
36"W x 14"D x 24"H	72	WOCB9-361424-T	\$706	WOCB9-361424-L	\$1,124
36"W x 14"D x 30"H	75	WOCB9-361430-T	\$735	WOCB9-361430-L	\$1,196
42"W x 14"D x 24"H	87	WOCB9-421424-T	\$719	WOCB9-421424-L	\$1,140
42"W x 14"D x 30"H	92	WOCB9-421430-T	\$751	WOCB9-421430-L	\$1,216
48"W x 14"D x 24"H	98	WOCB9-481424-T	\$720	WOCB9-481424-L	\$1,140
48"W x 14"D x 30"H	103	WOCB9-481430-T	\$751	WOCB9-481430-L	\$1,218

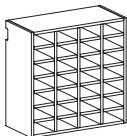

- 3 fixed vertical partitions
- 32 fixed shelves

Wall Cubicle Mail Storage (WOCBM)					
Melamine			High-Pressure Laminate		
Description	Wgt.	Model Number	List Price	Model Number	List Price
30"W x 14"D x 30"H	72	WOCBM-301430-T	\$937	WOCBM-301430-L	\$1,579
36"W x 14"D x 30"H	83	WOCBM-361430-T	\$1,086	WOCBM-361430-L	\$1,887



- 1 fixed vertical partition
- 4 adjustable shelves



- 2 fixed vertical partitions
- 6 adjustable shelves



- 3 fixed vertical partitions
- 32 fixed shelves

## Wall Cupboard Cubicle Storage - 6 Cubicles (WCCB6)

Description	Wgt.	Melamine		High-Pressure Laminate	
		Model Number	List Price	Model Number	List Price
18"W x 14"D x 24"H	50	WCCB6-181424-TT-H?P?N	\$1,115	WCCB6-181424-LL-H?P?N	\$1,136
18"W x 14"D x 30"H	56	WCCB6-181430-TT-H?P?N	\$1,153	WCCB6-181430-LL-H?P?N	\$1,198
24"W x 14"D x 24"H	63	WCCB6-241424-TT-H?P?N	\$1,183	WCCB6-241424-LL-H?P?N	\$1,196
24"W x 14"D x 30"H	70	WCCB6-241430-TT-H?P?N	\$1,245	WCCB6-241430-LL-H?P?N	\$1,267
30"W x 14"D x 24"H	75	WCCB6-301424-TT-H?P?N	\$1,249	WCCB6-301424-LL-H?P?N	\$1,331
30"W x 14"D x 30"H	83	WCCB6-301430-TT-H?P?N	\$1,284	WCCB6-301430-LL-H?P?N	\$1,393
36"W x 14"D x 24"H	87	WCCB6-361424-TT-H?P?N	\$1,334	WCCB6-361424-LL-H?P?N	\$1,535
36"W x 14"D x 30"H	96	WCCB6-361430-TT-H?P?N	\$1,393	WCCB6-361430-LL-H?P?N	\$1,602
42"W x 14"D x 24"H	105	WCCB6-421424-TT-H?P?N	\$1,420	WCCB6-421424-LL-H?P?N	\$1,636
42"W x 14"D x 30"H	116	WCCB6-421430-TT-H?P?N	\$1,478	WCCB6-421430-LL-H?P?N	\$1,729
48"W x 14"D x 24"H	118	WCCB6-481424-TT-H?P?N	\$1,423	WCCB6-481424-LL-H?P?N	\$1,638
48"W x 14"D x 30"H	130	WCCB6-481430-TT-H?P?N	\$1,479	WCCB6-481430-LL-H?P?N	\$1,730

## Wall Cupboard Cubicle Storage - 9 Cubicles (WCCB9)

Description	Wgt.	Melamine		High-Pressure Laminate	
		Model Number	List Price	Model Number	List Price
18"W x 14"D x 24"H	54	WCCB9-181424-TT-H?P?N	\$1,122	WCCB9-181424-LL-H?P?N	\$1,138
18"W x 14"D x 30"H	59	WCCB9-181430-TT-H?P?N	\$1,154	WCCB9-181430-LL-H?P?N	\$1,201
24"W x 14"D x 24"H	68	WCCB9-241424-TT-H?P?N	\$1,185	WCCB9-241424-LL-H?P?N	\$1,198
24"W x 14"D x 30"H	75	WCCB9-241430-TT-H?P?N	\$1,221	WCCB9-241430-LL-H?P?N	\$1,269
30"W x 14"D x 24"H	82	WCCB9-301424-TT-H?P?N	\$1,258	WCCB9-301424-LL-H?P?N	\$1,334
30"W x 14"D x 30"H	89	WCCB9-301430-TT-H?P?N	\$1,285	WCCB9-301430-LL-H?P?N	\$1,394
36"W x 14"D x 24"H	111	WCCB9-361424-TT-H?P?N	\$1,336	WCCB9-361424-LL-H?P?N	\$1,538
36"W x 14"D x 30"H	104	WCCB9-361430-TT-H?P?N	\$1,395	WCCB9-361430-LL-H?P?N	\$1,603
42"W x 14"D x 24"H	115	WCCB9-421424-TT-H?P?N	\$1,423	WCCB9-421424-LL-H?P?N	\$1,638
42"W x 14"D x 30"H	126	WCCB9-421430-TT-H?P?N	\$1,479	WCCB9-421430-LL-H?P?N	\$1,730
48"W x 14"D x 24"H	129	WCCB9-481424-TT-H?P?N	\$1,432	WCCB9-481424-LL-H?P?N	\$1,639
48"W x 14"D x 30"H	141	WCCB9-481430-TT-H?P?N	\$1,480	WCCB9-481430-LL-H?P?N	\$1,736

## Wall Cupboard Cubicle Mail Storage (WCCBM)

Description	Wgt.	Melamine		High-Pressure Laminate	
		Model Number	List Price	Model Number	List Price
30"W x 14"D x 30"H	96	WCCBM-301430-TT-H?P?N	\$1,834	WCCBM-301430-LL-H?P?N	\$2,106
36"W x 14"D x 30"H	112	WCCBM-361430-TT-H?P?N	\$2,041	WCCBM-361430-LL-H?P?N	\$2,480



- 1 fixed vertical partition
- 20 fixed shelves

Wall Open Folio Storage (WOF)					
Melamine			High-Pressure Laminate		
Description	Wgt.	Model Number	List Price	Model Number	List Price
20"W x 14"D x 24"H	52	WOF-201424-T	\$1,001	WOF-201424-L	\$1,198
20"W x 14"D x 30"H	55	WOF-201430-T	\$1,028	WOF-201430-L	\$1,274
30"W x 14"D x 24"H	62	WOF-301424-T	\$1,125	WOF-301424-L	\$1,357
30"W x 14"D x 30"H	65	WOF-301430-T	\$1,160	WOF-301430-L	\$1,435
36"W x 14"D x 24"H	72	WOF-361424-T	\$1,236	WOF-361424-L	\$1,518
36"W x 14"D x 30"H	75	WOF-361430-T	\$1,265	WOF-361430-L	\$1,593



- 1 fixed vertical partition
- 20 fixed shelves

Wall Cupboard Folio Storage (WCF)					
Melamine			High-Pressure Laminate		
Description	Wgt.	Model Number	List Price	Model Number	List Price
20"W x 14"D x 24"H	68	WCF-201424-TT-H?P?N	\$1,457	WCF-201424-LL-H?P?N	\$1,365
20"W x 14"D x 30"H	75	WCF-201430-TT-H?P?N	\$1,516	WCF-201430-LL-H?P?N	\$1,468
30"W x 14"D x 24"H	82	WCF-301424-TT-H?P?N	\$1,642	WCF-301424-LL-H?P?N	\$1,550
30"W x 14"D x 30"H	89	WCF-301430-TT-H?P?N	\$1,693	WCF-301430-LL-H?P?N	\$1,650
36"W x 14"D x 24"H	95	WCF-361424-TT-H?P?N	\$1,808	WCF-361424-LL-H?P?N	\$1,767
36"W x 14"D x 30"H	104	WCF-361430-TT-H?P?N	\$1,858	WCF-361430-LL-H?P?N	\$1,868

Wall Terminating End Panel - WTEPR					
Melamine			High-Pressure Laminate		
Description	Wgt.	Model Number	List Price	Model Number	List Price
1"T x 14"D x 31"H		WTEPR-362434-T	\$175	WTEPR-362434-L	\$250
1"T x 20"D x 34"H		WTEPR-422434-T	\$250	WTEPR-422434-L	\$357
1"T x 24"D x 36"H		WTEPR-482434-T	\$300	WTEPR-482434-L	\$428

Base Terminating End Panel - WTEPL					
Melamine			High-Pressure Laminate		
Description	Wgt.	Model Number	List Price	Model Number	List Price
1"T x 14"D x 31"H		WTEPL-362434-T	\$175	WTEPL-362434-L	\$250
1"T x 20"D x 34"H		WTEPL-422434-T	\$250	WTEPL-422434-L	\$357
1"T x 24"D x 36"H		WTEPL-482434-T	\$300	WTEPL-482434-L	\$428

Set Up Charges and Upcharges for Non-Standard and Custom Finishes		
Model Number	Description	List Price
Non-Standard PVC	Upcharge, per color, per order, for non-standard PVC	\$947

## Terms & Conditions

**Prices:** All prices are F.O.B. the factory. Prices and specifications are subject to change without notice. Prices do not include applicable taxes, special handling or installation charges. Possession of a price list is not an offer to or agreement to sell. We reserve the right to change prices without notice. We are not responsible for typographical errors. In the event a price or description is found to be incorrect, the correct information will be communicated to you when the order is received.

**Credit Terms:** Open account status is only granted after a completed credit application is received and approved.

**Payment Terms:** Terms for open account are net 30 days. Terms for orders without open account will be determined by Silver Street, Incorporated on an order-by-order basis and may require prepayment or a 50% deposit with order and the balance prepaid before shipment.

**Orders:** Orders must be in writing. Faxed orders are acceptable. Processing of orders will not begin until a signed acknowledgment is received.

**Acknowledgments:** Orders are accepted, manufactured and invoiced based on written acknowledgments issued by Silver Street, Incorporated. All orders are considered correct as acknowledged. Notify Silver Street, Incorporated immediately of any order discrepancies. Acknowledged orders may not be changed or canceled without written consent from Silver Street, Incorporated.

**Changes to orders:** Changes to orders already in process may be subject to a fee covering the cost to make the requested change. If a fee is necessary a written authorization of acceptance will be required. All requests for changes are subject to approval by Silver Street, Incorporated.

**Cancellation of orders:** All orders received by Silver Street, Incorporated are considered firm and cannot be canceled without our approval. A cancellation fee may be required based upon cost incurred by Silver Street, Incorporated prior to receipt of a cancellation request.

**Returns:** Returns are not accepted without a Return Goods Authorization issued by Silver Street, Incorporated. Unauthorized returns will not be accepted. Returns may be subject to a restocking fee.

**Shipping Terms:** All orders will be shipped F.O.B. shipping point with freight charged collect. Shipping weights listed are net.

**Routing:** Shipments will be routed "best way" or as specified. Instructions will be followed as closely as possible, however, Silver Street, Incorporated reserves the right to make changes due to local conditions or other circumstances.

**Freight Damage:** Legal title to merchandise passes to the buyer upon acceptance by the carrier. All cartons must be carefully inspected at the time of delivery. Visible damage should be noted on the delivery receipt. In the case of concealed damage, the carrier must be notified within (5) days. It is the buyer's obligation to seek recourse against the shipper.

**Shortages:** Shipments should be inspected upon receipt for shortages. Shortages must be reported to Silver Street, Incorporated in writing within (5) days of receipt.

### Shipping Address:

mediatechnologies®  
892 Industrial Park Drive  
Shelby, MI 49455

**Warranty:** All items manufactured by Silver Street, Incorporated, home of mediatechnologies® and Elements by mediatechnologies are guaranteed against defects for a period of five (5) years from the date of purchase. We will repair or replace, in our discretion, any defective item without cost to our customer. This is customer's sole and exclusive remedy against us. No delay in shipment or delivery shall give rise to any liability for damages whatsoever. We are not liable for defects caused by customer or any third party. Customer is not authorized to make any repairs whatsoever or to deduct any amount from the purchase price. In no event shall our liability under this warranty exceed the purchase price. In no event shall we be liable for incidental, special or consequential damages. We disclaim all other warranties, express or implied, as to any matter whatsoever, including without limitation, quality, design, performance, specifications, samples, condition, merchantability and fitness for any particular purpose. No action may be commenced for breach of the warranty more than six months after the cause of action accrues and any such action may only be brought in the county of Oceana, State of Michigan.

elements

by mediatechnologies®

is a registered trademark of Silverstreet Incorporated.

U.S. Patent # 8,434,835 B2