

# Modular Circulations Desks

## General Specifications - Circulation Desks

**Modular Case System:** Each case module is fully assembled, allowing for simple field assembly of the complete circulation desk as well as for easy reconfiguration, if necessary. Cases connect with male/female threaded metal connectors.

**Top:** Tops are 1-1/4" thick, three ply engineered wood construction with .050" High pressure laminate, HPL, and a phenolic backer sheet. The patron side is edged with 5/16" x 1-1/4" solid red oak (with the exception on the Malibu and Keystone design have 1-5/8" with a 1/4" radius top and bottom. The edges and back side of the top are edged with 1/8" solid red oak.

**Case Construction:** Circulation desk modules are constructed of 3/4" thick, three ply particleboard with plain sliced "A" grade oak veneer. All modules, except Malibu style, utilize a continuous front design (sides do not penetrate), with a 4" High recessed toe. Cabinets are assembled using glue and dowel joinery. Note: One Terminating End Panel is required for each exposed end of a complete desk assembly.

**Adjustable Shelves:** Adjustable shelves are 3/4" thick three ply particleboard plywood with "A" grade oak veneer faces. The exposed edges are edged with 1/8" solid red oak. Shelves are adjustable on 32mm increments.

**Drawers:** Drawers are constructed of 1/2" nine ply baltic birch plywood. Drawers have 3/4" thick fronts with "A" grade oak veneer. Box drawers have 100 lb. full extension slides, file drawers have 100 lb. full extension slides.

**Doors:** Doors are constructed of 3/4" thick, three ply particleboard with plain sliced "A" grade oak veneer faces and edged on all sides with 1/8" solid red oak. Door hardware includes concealed hinges, fully adjustable in all 3 axes, and wire pulls.

**Continuous Top Construction:** Tops may be specified as continuous.

**Locks:** Units may be specified with doors and or drawers locking, keyed random or alike.

**Design Lines:** mediatechnologies® offers seven design lines of circulation desk modules, all using the general construction specifications above.

To specify a design line you must include a letter indicator: No letter indicator will specify our standard Bookmark design.

**M**-Metro      **L**-Lexington      **H**-Heritage      **MB**-Malibu  
**CL**-Charleston      **KS**-Keystone

Please see below for design descriptions

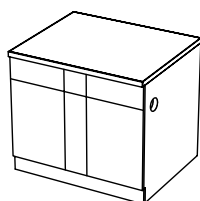

**Metro:** a clean and stylish design line detailed with 1/8" deep x 1/8" wide grooves painted black applied to the patron side of most modular units. Model Number example for Metro Desk unit; MCD-M-36D-29

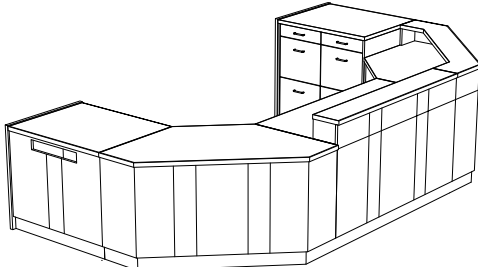

Desk Units				
36" Wide	Model Number	Description	Wgt.	List Price
	MCD-M-36D-29	Desk Unit, 36"W X 30"D X 29" H	116	\$2,965
	MCD-M-36D-32	Desk Unit, 36"W X 30"D X 32" H	122	\$2,965
	MCD-M-36D-39	Desk Unit, 36"W X 30"D X 39" H	137	\$3,139
	MCD-M-36D-32-ADJ	Desk Unit, 36"W X 30"D X ADJ. H	122	\$3,230
48" Wide	Model Number	Description	Wgt.	
	MCD-M-48D-29	Desk Unit, 48"W X 30"D X 29" H	127	\$3,945
	MCD-M-48D-32	Desk Unit, 48"W X 30"D X 32" H	134	\$3,945
	MCD-M-48D-39	Desk Unit, 48"W X 30"D X 39" H	149	\$4,183
	MCD-M-48D-32-ADJ	Desk Unit, 48"W X 30"D X ADJ. H	134	\$4,301
72" Wide	Model Number	Description	Wgt.	
	MCD-M-72D-29	Desk Unit, 72"W X 30"D X 29" H	201	\$6,021
	MCD-M-72D-32	Desk Unit, 72"W X 30"D X 32" H	208	\$6,021
	MCD-M-72D-39	Desk Unit, 72"W X 30"D X 39" H	226	\$6,042
	MCD-M-72D-32-ADJ	Desk Unit, 72"W X 30"D X ADJ. H	208	\$4,875
Book Return	Model Number	Description	Wgt.	
	MCD-M-36BR-29	Book Return, 36"W X 30"D X 29" H	115	\$3,162
	MCD-M-36BR-32	Book Return, 36"W X 30"D X 32" H	121	\$3,162
	MCD-M-36BR-39	Book Return, 36"W X 30"D X 39" H	136	\$3,343
Descending Platform Book Truck	Model Number	Description	Wgt.	
	MCD-DBT-1824-21	Depressible Platform Book Truck, 18"D x 24.25"W x 21"H, For curved 29"H Book Return Units and Nomad Book Return	135	\$3,407
	MCD-DBT-1824-24	Depressible Platform Book Truck, 18"D x 24.25"W x 24"H, For Curved 32"-39"H Book Return Units	135	\$3,407
	MCD-DBT-2424-21	Depressible Platform Book Truck, 23.625"D x 24.25"W x 21"H, For 29"H Book Return Units with Extended Chutes and 32"H Keystone and Malibu Book Returns	137	\$3,407
	MCD-DBT-2424-24	Depressible Platform Book Truck, 23.625"D x 24.25"W x 24"H, For 32" and #1"H Book Return Units	137	\$3,407
Top Surface Slot Book Return Module with Drawer and Shelf Storage	Model Number	Description	Wgt.	
	MCD-M-36SBR-TOP-29	Book Return w Top Slot, 36"W X 30"D X 29" H	198	\$4,512
	MCD-M-36SBR-TOP-32	Book Return w Top Slot, 36"W X 30"D X 32" H	201	\$4,512
	MCD-M-36SBR-TOP-39	Book Return w Top Slot, 36"W X 30"D X 39" H	215	\$4,551

## Circulation Desks

Cupboard Units	Model Number	Description	Wgt.	
	MCD-M-36CS-29	Cupboard Unit, 36"W X 30"D X 29" H	187	\$4,416
	MCD-M-36CS-32	Cupboard Unit, 36"W X 30"D X 32" H	190	\$4,416
	MCD-M-36CS-39	Cupboard Unit, 36"W X 30"D X 39" H	208	\$4,459
Cupboard Unit With Drawer	Model Number	Description	Wgt.	
	MCD-M-36CD-29	Cupboard Unit, 36"W X 30"D X 29" H with drawer	199	\$5,052
	MCD-M-36CD-32	Cupboard Unit, 36"W X 30"D X 32" H with drawer	205	\$5,052
	MCD-M-36CD-39	Cupboard Unit, 36"W X 30"D X 39" H with drawer	223	\$5,096
Cupboard Unit With 2 & 3 Drawers (Cupboard Left)	Model Number	Description	Wgt.	
	MCD-M-36C2DL-29	Cupboard Unit, Left, 36"W X 30"D X 29" H with 2 drawers, file/file	220	\$6,404
	MCD-M-36C2DL-32	Cupboard Unit, Left, 36"W X 30"D X 32" H with 2 drawers, file/file	223	\$6,404
	MCD-M-36C3DL-32	Cupboard Unit, Left, 36"W X 30"D X 32" H with 3 drawers, box/box/file	228	\$6,655
	MCD-M-36C3DL-39	Cupboard Unit, Left, 36"W X 30"D X 39" H with 3 drawers, box/file/file	254	\$6,710
Cupboard Unit With 2 & 3 Drawers (Cupboard Right)	Model Number	Description	Wgt.	
	MCD-M-36C2DR-29	Cupboard Unit, Right, 36"W X 30"D X 29" H with 2 drawers, file/file	220	\$6,404
	MCD-M-36C2DR-32	Cupboard Unit, Right, 36"W X 30"D X 32" H with 2 drawers, file/file	223	\$6,404
	MCD-M-36C3DR-32	Cupboard Unit, Right, 36"W X 30"D X 32" H with 3 drawers, box/box/file	228	\$6,655
	MCD-M-36C3DR-39	Cupboard Unit, Right, 36"W X 30"D X 39" H with 3 drawers, box/file/file	254	\$6,710
Cupboard Unit With Open Storage (Cupboard Left)	Model Number	Description	Wgt.	
	MCD-M-36COSL-29	Cupboard Unit, Left, 36"W X 30"D X 29" H with open storage	184	\$4,618
	MCD-M-36COSL-32	Cupboard Unit, Left, 36"W X 30"D X 32" H with open storage	188	\$4,618
	MCD-M-36COSL-39	Cupboard Unit, Left, 36"W X 30"D X 39" H with open storage	202	\$4,677
Cupboard Unit With Open Storage (Cupboard Right)	Model Number	Description	Wgt.	
	MCD-M-36COSR-29	Cupboard Unit, Right, 36"W X 30"D X 29" H with open storage	184	\$4,618
	MCD-M-36COSR-32	Cupboard Unit, Right, 36"W X 30"D X 32" H with open storage	188	\$4,618
	MCD-M-36COSR-39	Cupboard Unit, Right, 36"W X 30"D X 39" H with open storage	202	\$4,677
Open Storage Units	Model Number	Description	Wgt.	
	MCD-M-36OS-29	Open Storage, 36"W X 30"D X 29" H	183	\$3,577
	MCD-M-36OS-32	Open Storage, 36"W X 30"D X 32" H	186	\$3,577
	MCD-M-36OS-39	Open Storage, 36"W X 30"D X 39" H	200	\$3,605
Open Storage Unit With Drawer	Model Number	Description	Wgt.	
	MCD-M-36OSD-29	Open Storage, 36"W X 30"D X 29" H with drawer	198	\$4,347
	MCD-M-36OSD-32	Open Storage, 36"W X 30"D X 32" H with drawer	201	\$4,347
	MCD-M-36OSD-39	Open Storage, 36"W X 30"D X 39" H with drawer	215	\$4,387

## Circulation Desks

Open Storage Unit With 2 & 3 Drawers (Open Storage Left)	Model Number	Description	Wgt.	
	MCD-M-360S2DL-29	Open Storage, Left, 36"W X 30"D X 29" H with 2 drawers, file/file	207	\$6,248
	MCD-M-360S2DL-32	Open Storage, Left, 36"W X 30"D X 32" H with 2 drawers, file/file	210	\$6,248
	MCD-M-360S3DL-32	Open Storage, Left, 36"W X 30"D X 32" H with 3 drawers, box/box/file	218	\$6,462
	MCD-M-360S3DL-39	Open Storage, Left, 36"W X 30"D X 39" H with 3 drawers, box/file/file	238	\$6,732
Open Storage Unit With 2 & 3 Drawers (Open Storage Right)	Model Number	Description	Wgt.	
	MCD-M-360S2DR-29	Open Storage, Right, 36"W X 30"D X 29" H with 2 drawers, file/file	207	\$6,248
	MCD-M-360S2DR-32	Open Storage, Right, 36"W X 30"D X 32" H with 2 drawers, file/file	210	\$6,248
	MCD-M-360S3DR-32	Open Storage, Right, 36"W X 30"D X 32" H with 3 drawers, box/box/file	218	\$6,462
	MCD-M-360S3DR-39	Open Storage, Right, 36"W X 30"D X 39" H with 3 drawers, box/file/file	238	\$6,732
Kneespace Unit	Model Number	Description	Wgt.	
	MCD-M-36KS-32	Kneespace Unit, 36"W X 30"D X 32" H	136	\$4,104
	MCD-M-36KS-39	Kneespace Unit, 36"W X 30"D X 39" H	149	\$4,137
Corner Units				
45 Degree Radius	Model Number	Description	Wgt.	
	MCD-M-30RC45-29	Radius Corner, 30"W X 30"D X 29" H	74	\$3,924
	MCD-M-30RC45-32	Radius Corner, 30"W X 30"D X 32" H	77	\$3,924
	MCD-M-30RC45-39	Radius Corner, 30"W X 30"D X 39" H	84	\$4,304
45 Degree Flat	Model Number	Description	Wgt.	
	MCD-M-30FC45-29	Flat Corner, 30"W X 30"D X 29" H	74	\$3,924
	MCD-M-30FC45-32	Flat Corner, 30"W X 30"D X 32" H	77	\$3,924
	MCD-M-30FC45-39	Flat Corner, 30"W X 30"D X 39" H	84	\$4,304
90 Degree Radius	Model Number	Description	Wgt.	
	MCD-M-30RC-29	Radius Corner, 30"W X 30"D X 29" H	148	\$4,092
	MCD-M-30RC-32	Radius Corner, 30"W X 30"D X 32" H	153	\$4,092
	MCD-M-30RC-39	Radius Corner, 30"W X 30"D X 39" H	168	\$4,290
90 Degree Extended Radius	Model Number	Description	Wgt.	
	MCD-M-30ERC-29	Radius Ext. Corner, 66"W X 34"D X 29" H	276	\$8,503
	MCD-M-30ERC-32	Radius Ext. Corner, 66"W X 34"D X 32" H	284	\$8,503
	MCD-M-30ERC-39	Radius Ext. Corner, 66"W X 34"D X 39" H	306	\$8,728
90 Degree Extended Flat	Model Number	Description	Wgt.	
	MCD-M-30EFC-29	Flat Ext. Corner, 66"W X 30"D X 29" H	164	\$7,310
	MCD-M-30EFC-32	Flat Ext. Corner, 66"W X 30"D X 32" H	173	\$7,310
	MCD-M-30EFC-39	Flat Ext. Corner, 66"W X 30"D X 39" H	190	\$7,500

90 Degree Square	Model Number	Description	Wgt.	
	MCD-M-30SC-29	Square Corner, 30"W X 30"D X 29"H	150	\$3,305
	MCD-M-30SC-32	Square Corner, 30"W X 30"D X 32"H	155	\$3,305
	MCD-M-30SC-39	Square Corner, 30"W X 30"D X 39"H	170	\$3,464

Triangle Corner Unit	Model Number	Description	Wgt.	
	MCD-M-30TC-29	Triangle Corner, 30"W X 30"D X 29" H	87	\$3,305
	MCD-M-30TC-32	Triangle Corner, 30"W X 30"D X 32" H	89	\$3,305
	MCD-M-30TC-39	Triangle Corner, 30"W X 30"D X 39" H	97	\$3,470

\* Note: For Triangle Corner Unit with Shelves, use Bookmark MCD-TCS units.

## Circulation Desk End Panels

Note: One Terminating End Panel is required for each exposed end of a complete desk assembly. End Panels are available in all standard design lines. Terminating end panels are available to create right or left facing units. Right side and left side is determined from the perspective of the desk user.

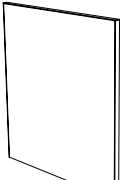
Metro	Model Number	Description	Wgt.	Price
	MCD-M-29-EP-LH	Metro Finished Left End Panel for 29"H Unit	18	\$787
	MCD-M-29-EP-RH	Metro Finished Right End Panel for 29"H Unit	18	\$787
	MCD-M-32-EP-LH	Metro Finished Left End Panel for 32"H Unit	19	\$787
	MCD-M-32-EP-RH	Metro Finished Right End Panel for 32"H Unit	19	\$787
	MCD-M-39-EP-LH	Metro Finished Left End Panel for 39"H Unit	23	\$898
	MCD-M-39-EP-RH	Metro Finished Right End Panel for 39"H Unit	23	\$898

### Set Up Charges and Upcharges for Non-Standard and Custom Finishes

Model Number	Description	List Price
Non-Standard PVC	Upcharge, per color, per order, for non-standard PVC	\$947
Custom Finish	Upcharge for custom stain finish	\$701
Non-Standard Stain	Upcharge for non-standard stains already matched	\$304
Sprayon Finish	Upcharge, per color, per order, for Sprayon finish	\$361